



OWNER'S MANUAL

Gazebo

Includes instructions for 10' x 10' Gazebo
Assembled exterior dimensions: 11' 3"W. x 11' 3"D. x 11' 1"H.

Before You Begin...

- **Consult your local authorities for any permits required to construct gazebo.**
Prior to the construction of your gazebo, check with the local building code official to review any required permits or building limitations.
- **A level and sturdy foundation is required before gazebo construction can begin.**
Site preparation information is available in this manual. Please read before building gazebo.
- **Read instructions thoroughly prior to assembly.**
This kit contains parts that can be damaged if assembled incorrectly or in the wrong sequence.
- **Please follow instructions.**
Suncast is not responsible for replacing parts lost or damaged due to incorrect assembly.
- **Check for all parts before you begin assembly.**
Using the provided parts check list on pages 5 and 6, verify that you have all the parts required to construct your gazebo model. **COMPLETE SITE PREPARATION AND FOUNDATION CONSTRUCTION BEFORE UNPACKING ALL PARTS.**
- **Assistance is required.**
Due to the size of the parts, at least two people are required to handle, fit and secure gazebo components.

Gazebo Assembly Stages

There are four stages to assembling this gazebo. The end of each stage provides a good stopping point. Please read the instructions and set aside the appropriate amount of time for each stage.

- 1) Site preparation and platform construction
- 2) Support post installation
- 3) Parts preassembly
- 4) Gazebo assembly

Assembled Dimensions

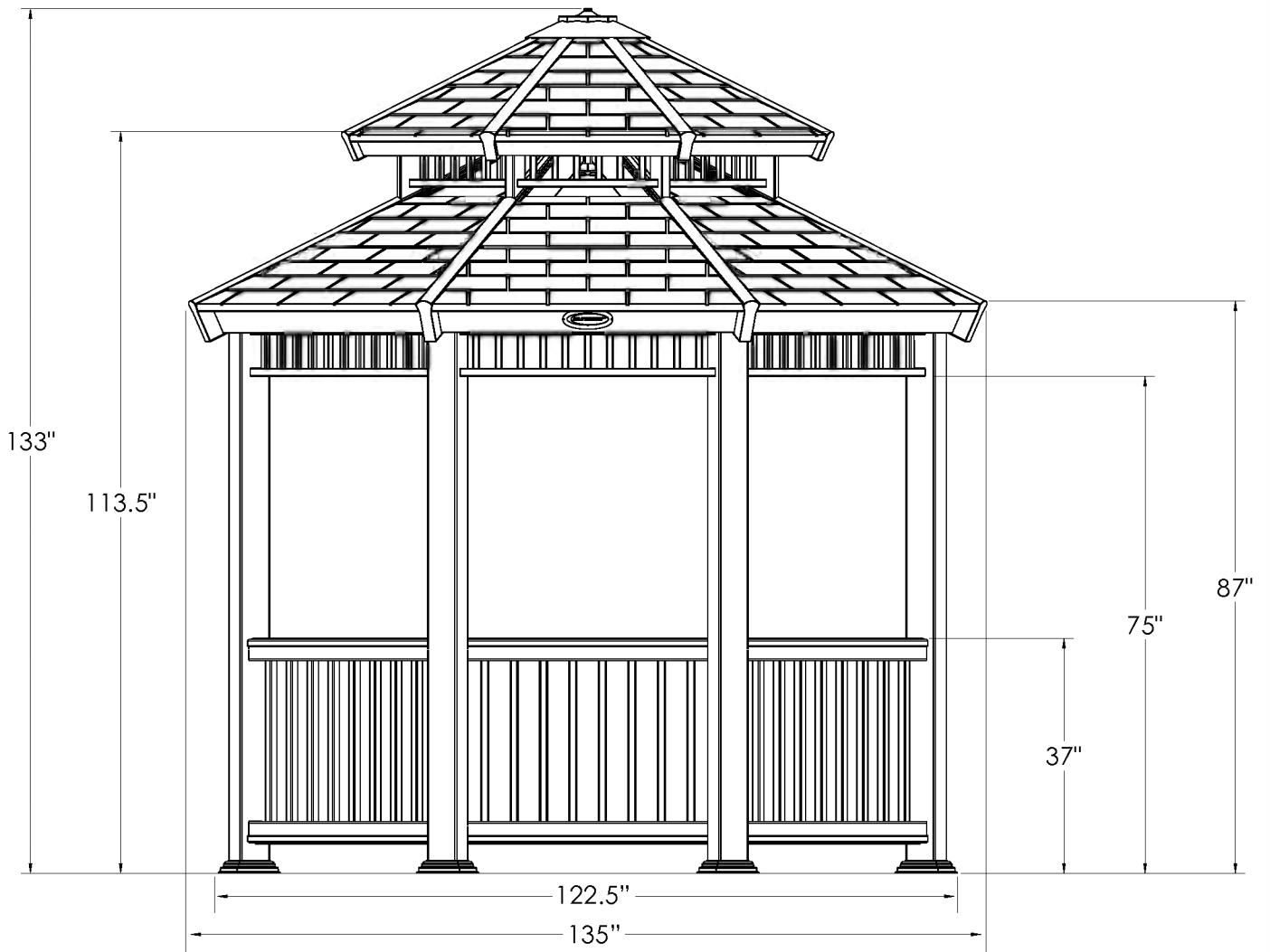



CAUTION

- Gazebo not intended for use in extreme weather conditions.
- Do not stand, sit, or store items on gazebo roof.
- Handle carefully in extreme temperatures.
- Repair or replace broken parts immediately.
- Sunbath is not responsible for damage caused by weather or misuse.
- At regular intervals inspect your gazebo to make sure that assembly integrity has been maintained.
- Periodically check that the location you have chosen to set your gazebo is still level.
- Avoid excess heat from any auxiliary source.
- Railing is not intended as a seat.
- Any additional holes drilled into parts could cause unsafe conditions.
- Gazebo is not intended to be enclosed.
- Follow manufacturer safety instructions when using ladder.
- Do not anchor to paver bricks. Foundation must be a solid surface.
- Exercise caution using a lawn mower, edge trimmer or other yard equipment near gazebo.
- Do not hang objects from Roof Rails.
- Do not hang objects from Facia Board.

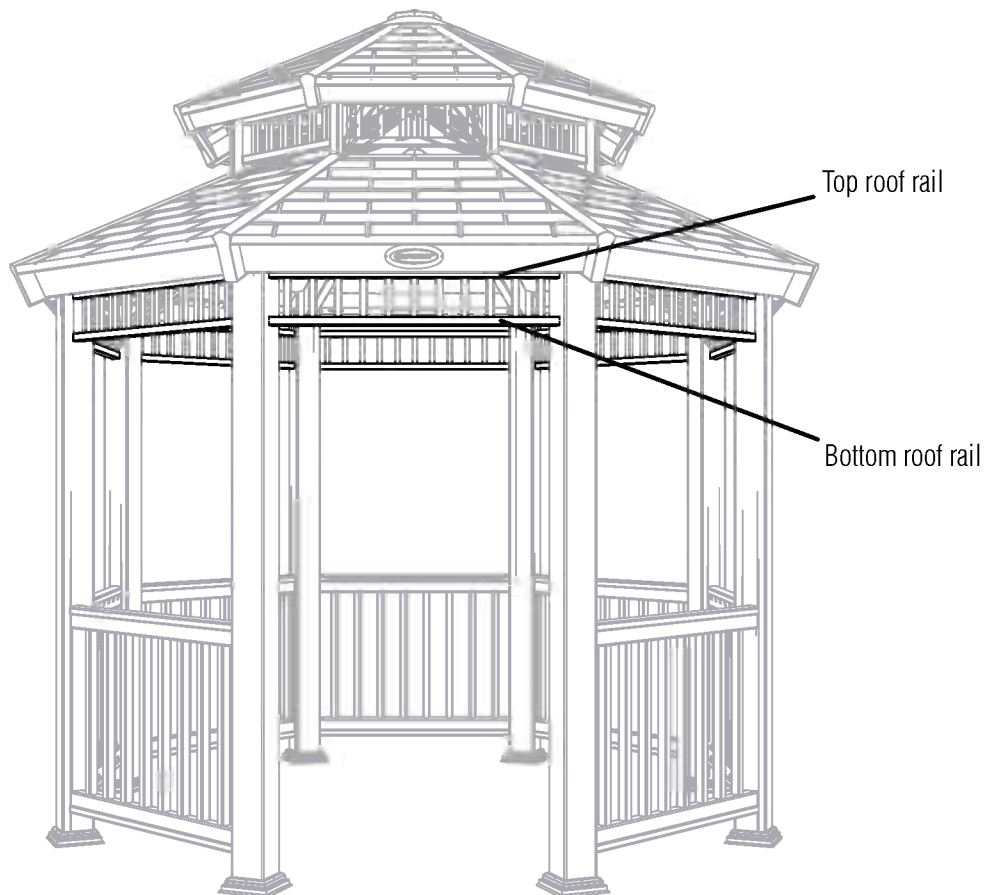

Gazebo Safety and Care

- Wash gazebo with garden hose or mild detergent solution and soft cloth. **DO NOT** use a stiff brush or abrasive cleaner as that could damage gazebo.
- Hot items, such as recently used grills, blowtorches, etc., must not be used in or near the gazebo.
- Heavy articles should not be leaned against the post and rails, as this may cause panel distortion and permanent damage.
- Keep roof clean of snow and leaves.

Tools Needed for Installation

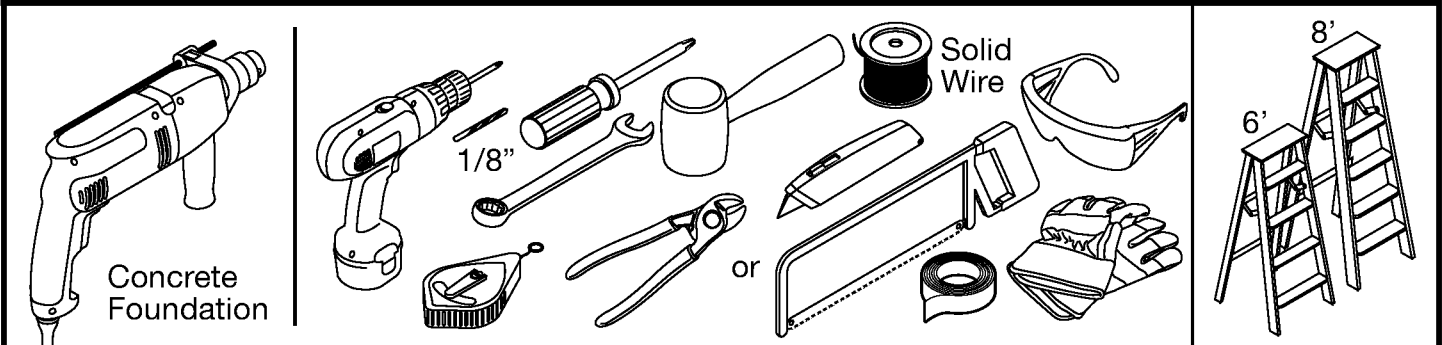

Assembly Day Tips

- **Complete site preparation and foundation construction before unpacking parts and beginning assembly.**
- **Take care when removing posts from carton. Other parts are packed inside them.**
- **DO NOT attempt to assemble on a day with strong winds.**
- **DO NOT attempt to assemble on days when temperature is below 32 degrees.**
- **Set aside appropriate amount of time to completely assemble gazebo.**
- **Make sure you have assistance nearby to lift and secure parts in place.**
- **Wear light duty work gloves while assembling gazebo.**
- **If you have questions on assembly, please call 800-846-2345.**

Note: This product contains parts that are used in different orientations to construct the gazebo. Please take note of the orientation of the parts shown throughout this instruction manual. Failure to follow instructions could result in damage to parts. Suncoast is not responsible for replacing parts lost or damaged due to incorrect assembly.

Parts

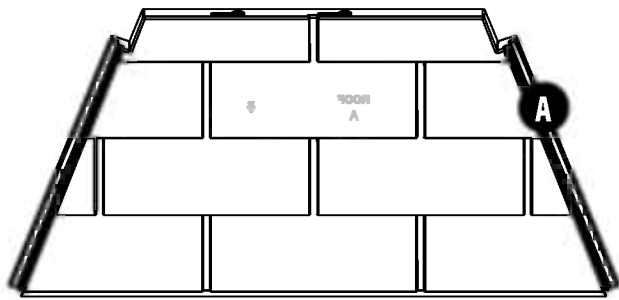

0101856A0 – Bottom upper shingle roof
x8

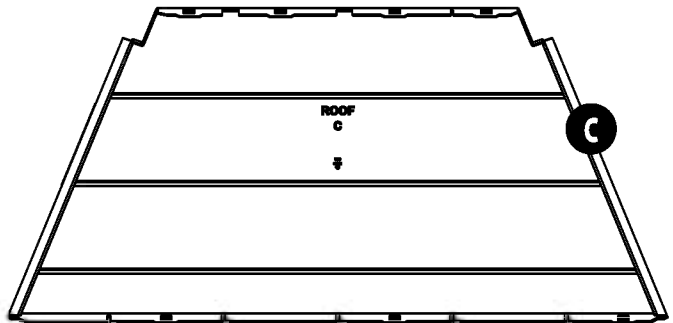

0101852A1 – Bottom upper underside roof
x8

Note: Parts D and B are pre-assembled.

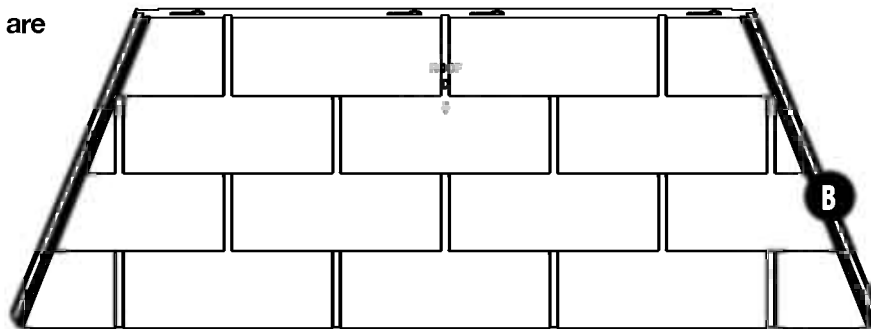

0101857A0 – Bottom lower shingle roof/0101853A1 – Bottom lower underside roof
x8

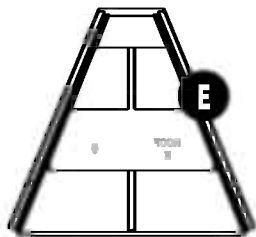

0101854A0 – Top upper shingle roof
x8

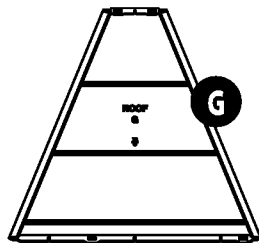

0101850A1 – Top upper underside roof
x8

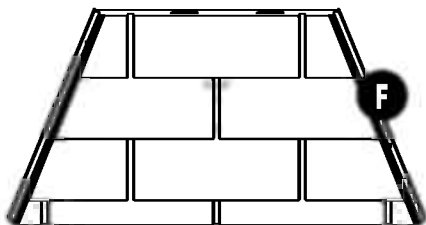

0101855A0 – Top lower shingle roof/
0101851A1 – Top lower underside roof
x8

Note: Parts H and F are pre-assembled.

Hardware

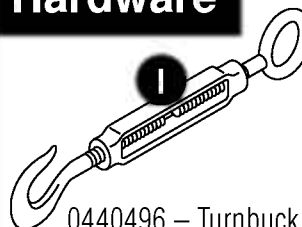

0440496 – Turnbuckle



0210152 – Stainless steel screw
x76



0440496 – Cable clamp
x2

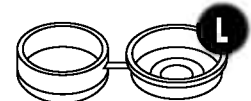

0240049 – Screw cap
x108



0510496 – 37.75' Cable



0210156 – Flat head screw
x64



0210160 – Pan head screw
x32



0510502 – Nylon spacer
x32

Parts

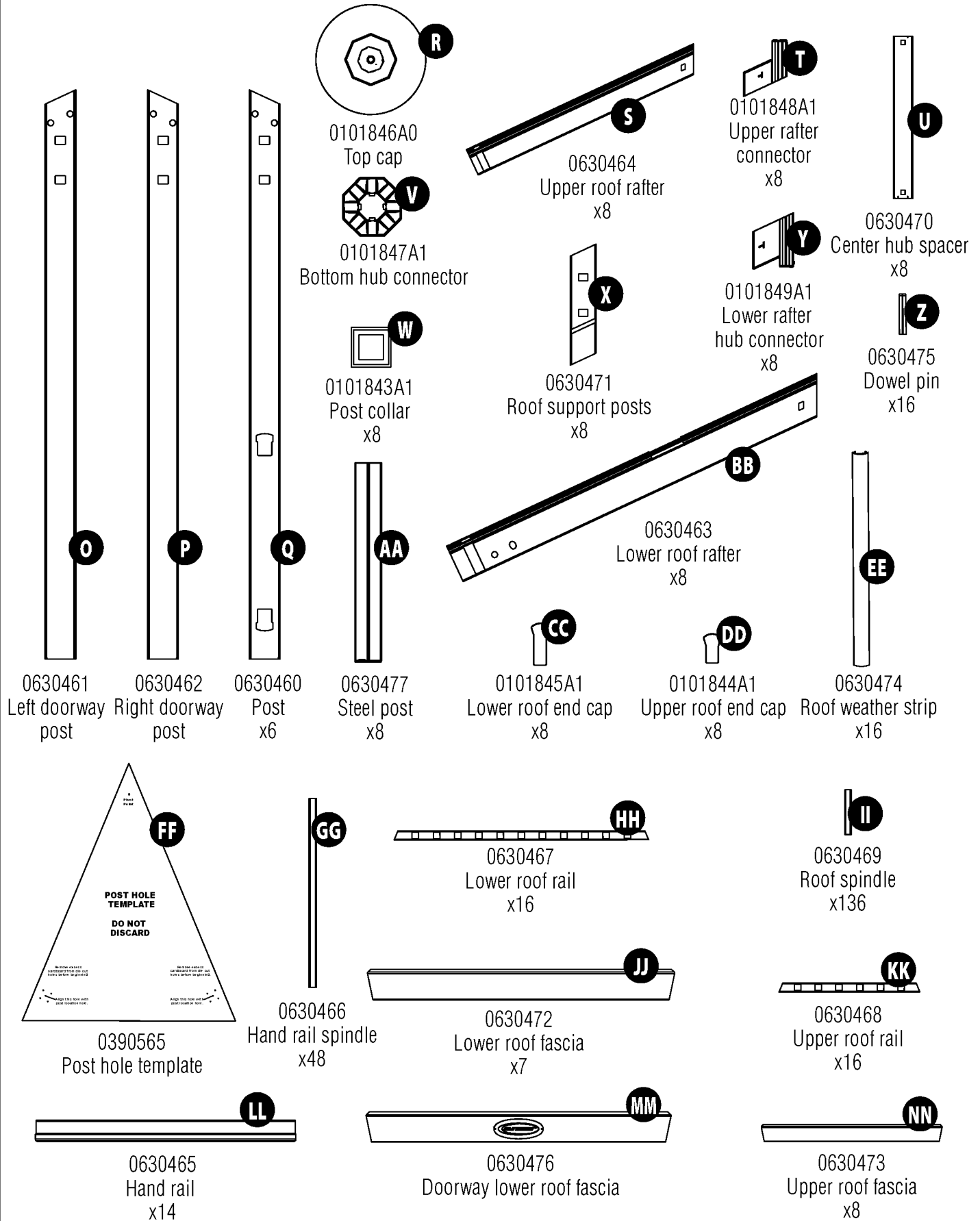

Site Preparation and Platform Construction

(Materials NOT supplied with Gazebo Kit)

Note: Site preparation and platform construction and Support Post Installation steps may require professional assistance to be installed correctly.

Please read all manual steps thoroughly before starting this project.

Note: Site preparation and platform construction **are required** for this gazebo. Placing the gazebo on the ground without any type of foundation is not recommended. Suncoast is not responsible for replacing parts damaged or property lost due to construction without a foundation or platform.

Complete the site preparation and platform construction before unpacking parts.

To prepare your gazebo site, follow the below steps:

- 1) Consult your local authorities for building codes and covenants before beginning foundation or erecting gazebo.
- 2) Consult your local building supply retailer to assist you in determining the best foundation or platform method for your application. The building supply retailer can also help you determine what anchoring hardware you will need once the foundation or platform method has been determined. Bring this manual with you to the retailer so they can see the scope of the project.
- 3) Before any digging, check with local utilities to determine location of buried cables, pipes, etc.
- 4) **A 4-inch thick concrete slab is recommended as the foundation.**
 - If a wood platform is chosen as the foundation, use exterior grade wood.

Note: DO NOT erect gazebo on paver bricks. Foundation must be a solid surface.

If you plan to erect the gazebo on an existing deck, consult local authorities for building codes and make sure that the structure is sound and can hold the additional weight of the gazebo (approx. 725 lbs.). Consult local building supply retailer to determine the best method and hardware for your application.

- 5) Preparing the building site:
 - The ground should slope away from the foundation area to provide drainage.
 - The foundation surface must be flat and level.
 - Follow local building codes for a proper vapor barrier.

Ensure site allows room for your gazebo:

- 1) Square foundation should be 10' 6" x 10' 6" minimum.
- 2) If an octagon foundation is wanted for your gazebo, consult your local building supply retailer to help you determine materials and hardware required.
- 3) Overall height (foundation to top of top cap) – 11' 1".
- 4) Overall base width (support post to support post) – 10' 2.5".
- 5) Overall roof width (rafter end to rafter end) – 11' 3".

Support Post Installation

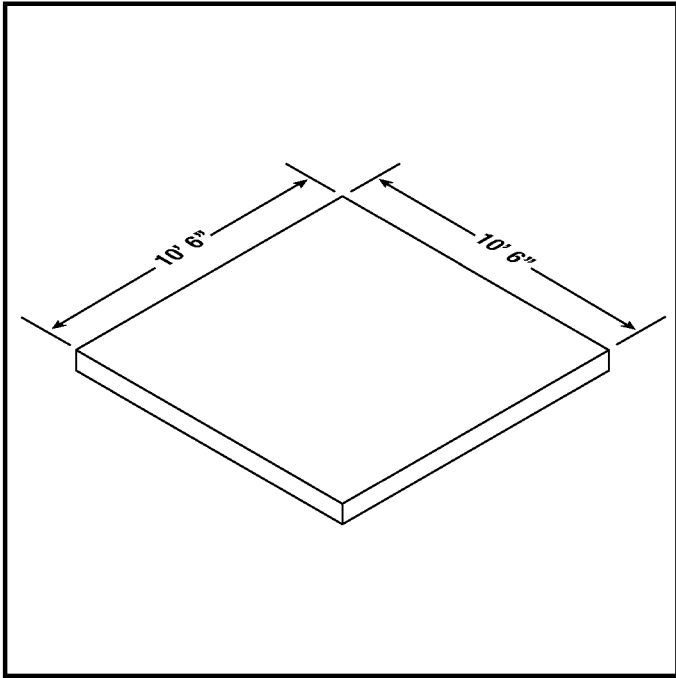

Ensure square foundation is 10' 6" x 10' 6".

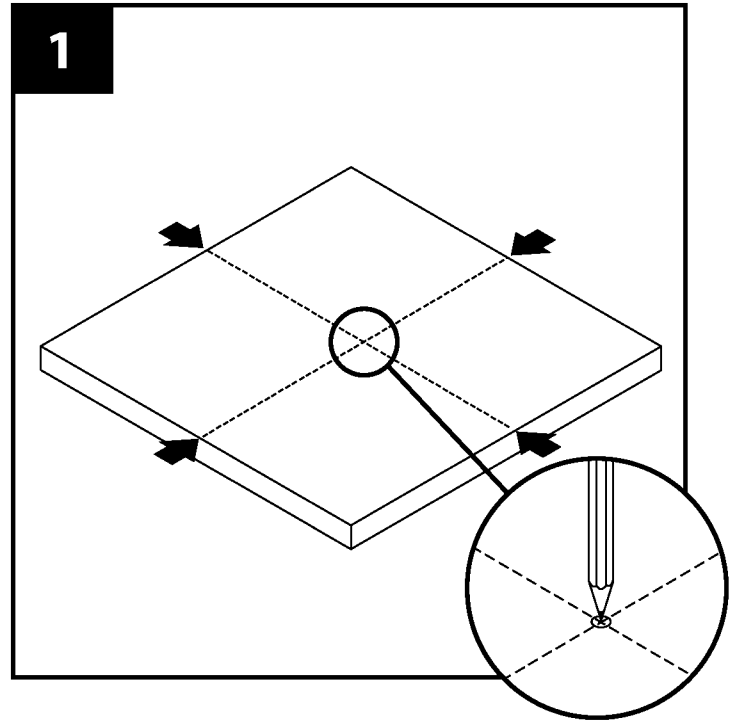

1
Locate and mark center point of foundation slab or deck.

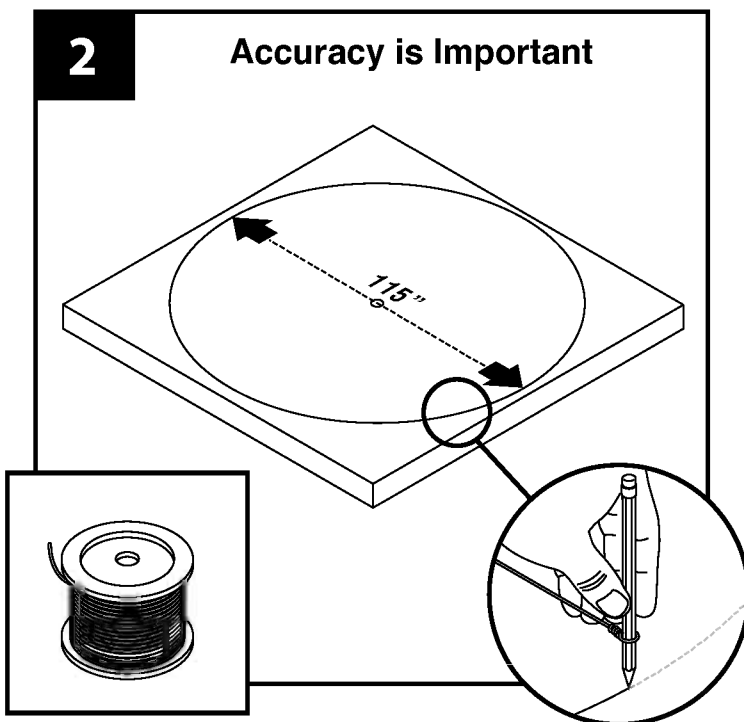

Anchor solid wire (not stranded) at center point, or have another person hold wire at center point to ensure accuracy. Draw a 115" diameter circle. **DO NOT** use string – use wire – string will stretch causing inaccurate measurements. Verify measurements before proceeding to step 3.

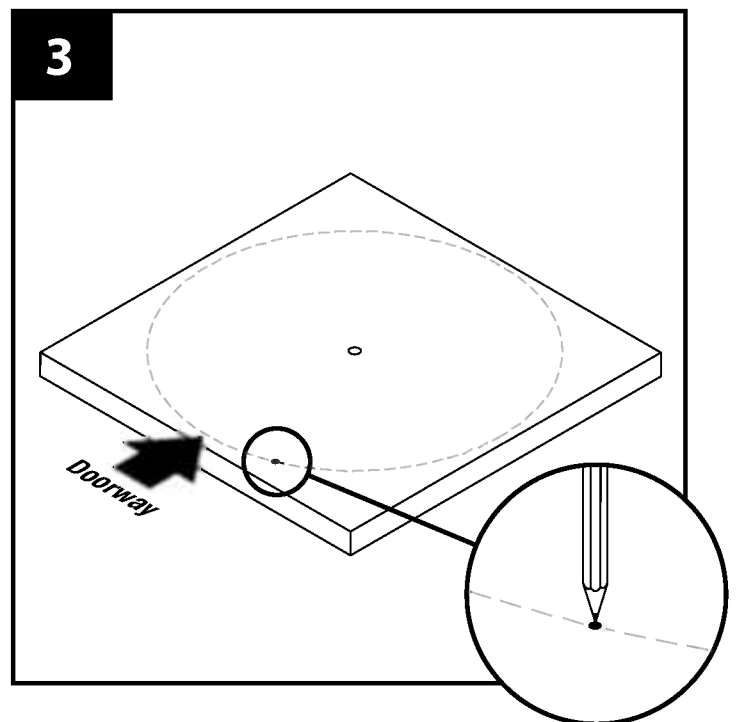

3
Determine doorway location and mark right doorway post location by drawing a circle with a pencil.

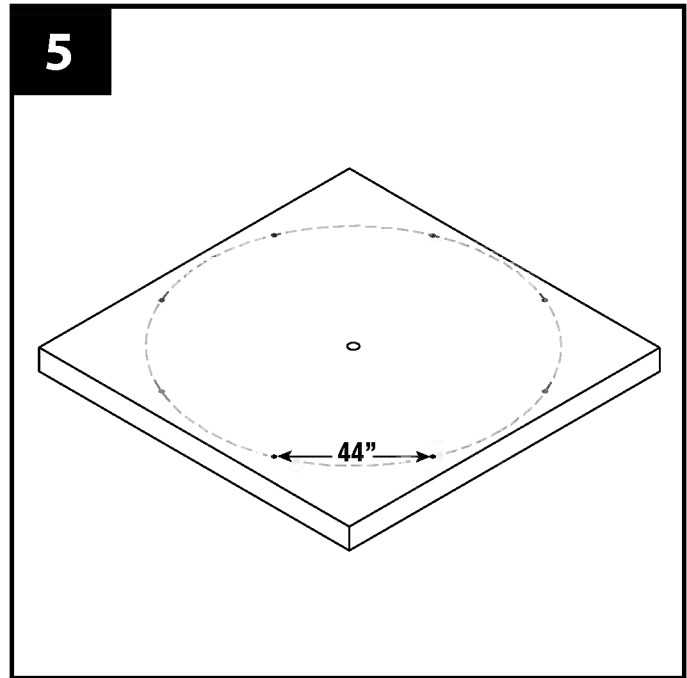
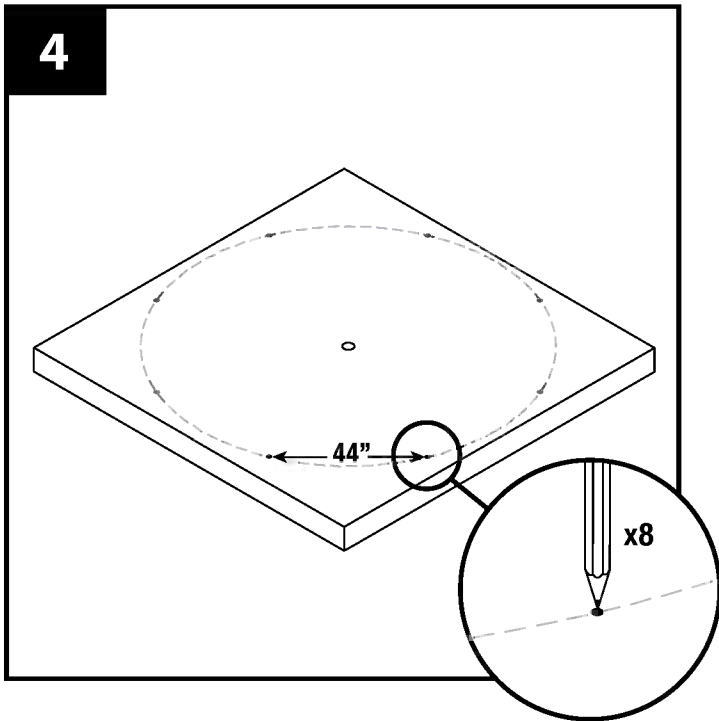

Measure 44" from the intersection of circle and post position to next post position. Measure directly from point to point, **NOT** along circle. Mark this spot by drawing a circle with a pencil. Do this eight times to identify all post locations.

Double check markings to ensure there are 44" between each post location.

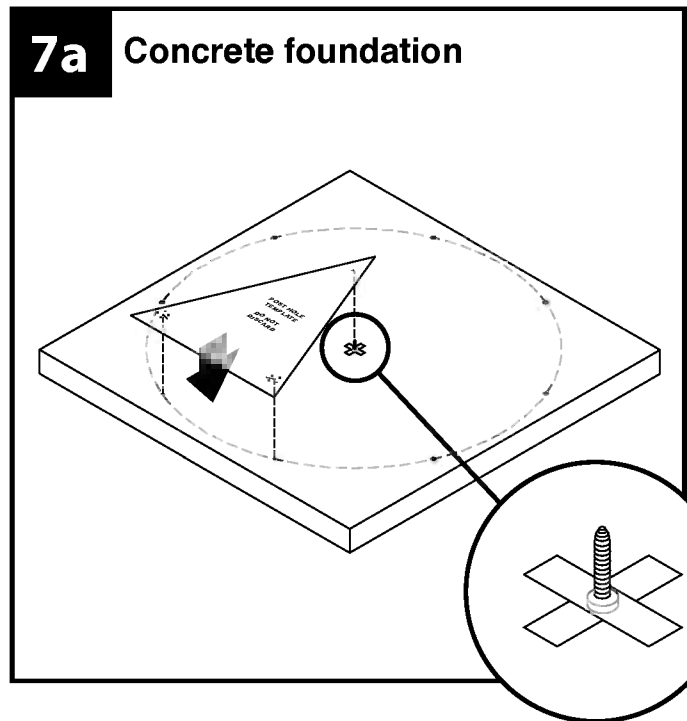
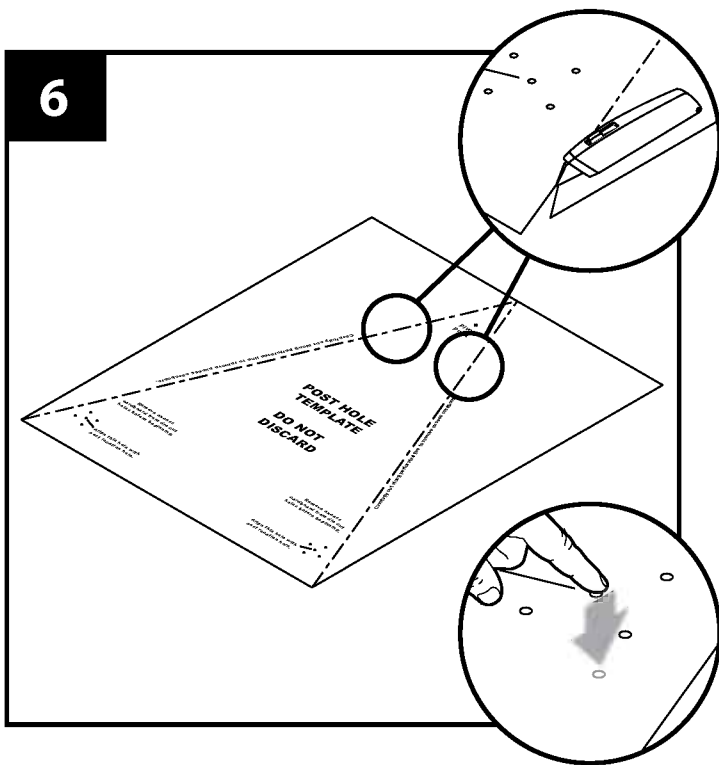

Unfold cardboard post hole template. With a utility knife, carefully cut along perforated line and remove excess cardboard to create the triangle shape of the post hole template. Carefully remove all excess cardboard from the die cut holes.

Concrete foundation

Position one screw, point facing upward, at the center point of foundation. Tape screw in place by placing two 6" pieces of tape over screw in an "X". **Take care to not step on screw.** Take post hole template and place "X" marked pivot point over screw.

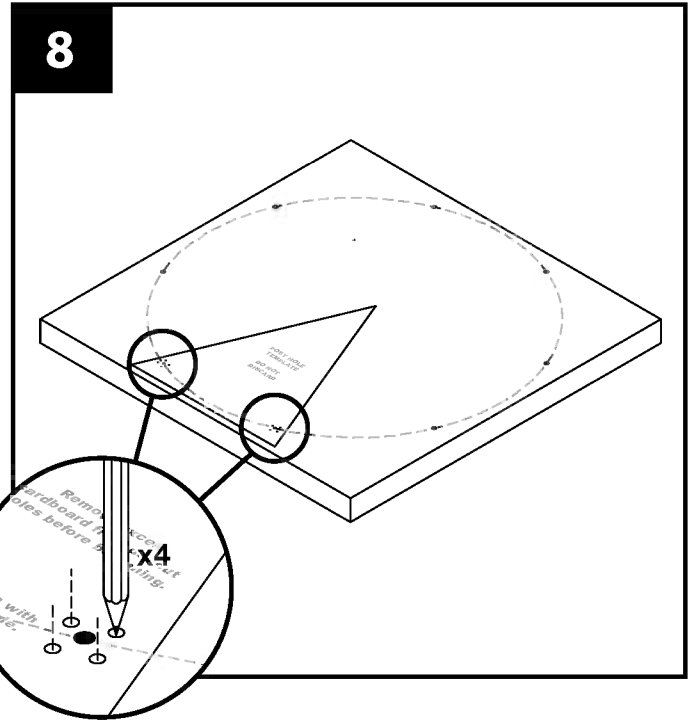
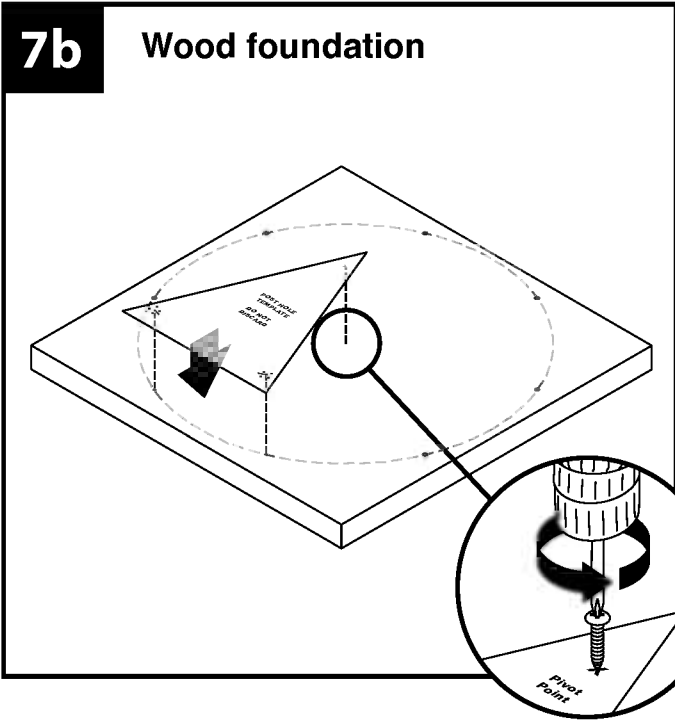

Wood foundation

Drill pilot hole in center point of foundation. Position post hole template so that "X" marked pivot point is centered over the center point of foundation. Drill screw through "X" and into foundation. **DO NOT** seat the screw; the template must be free to spin.

Line up post hole template so that the two sets of five holes align with the post hole location markings. The post hole location marked on the foundation must align with the center holes in the post hole template. Using a pencil, mark the four holes for each post location.

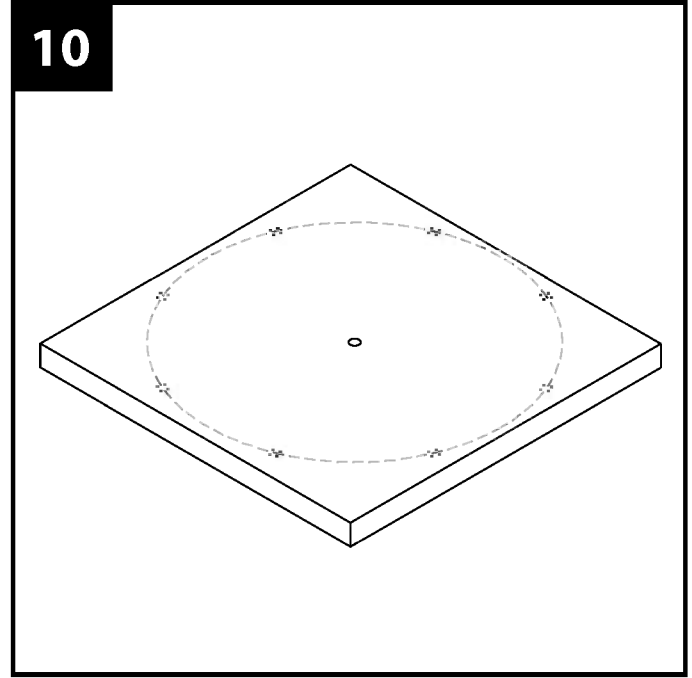
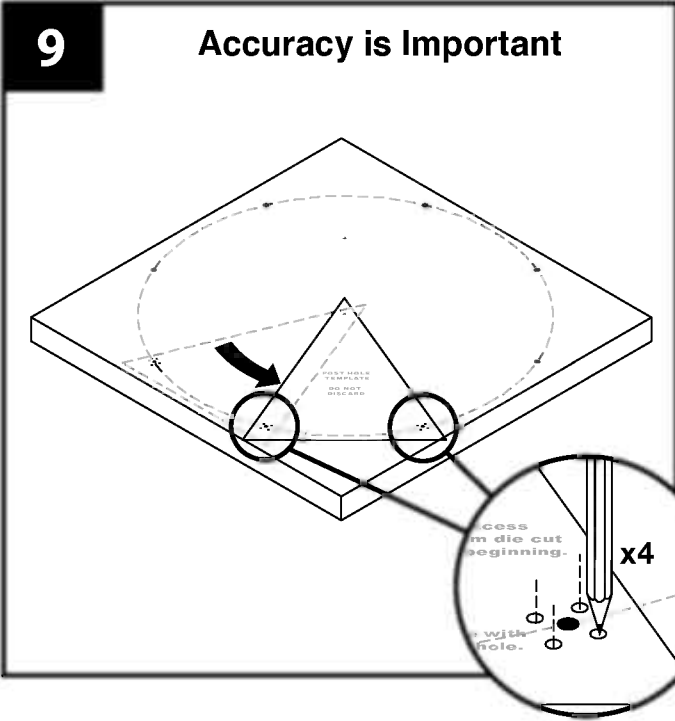

Carefully rotate the post hole template so that the holes align with the next set of post location markings and repeat step 8.

Repeat steps 8 and 9 until 4 post hole markings have been made for each post hole location marking. Verify all measurements are correct. When complete, remove post hole template and proceed to next step.

Note: Before drilling into foundation, check with local building supply retailer for best method and hardware for your application.

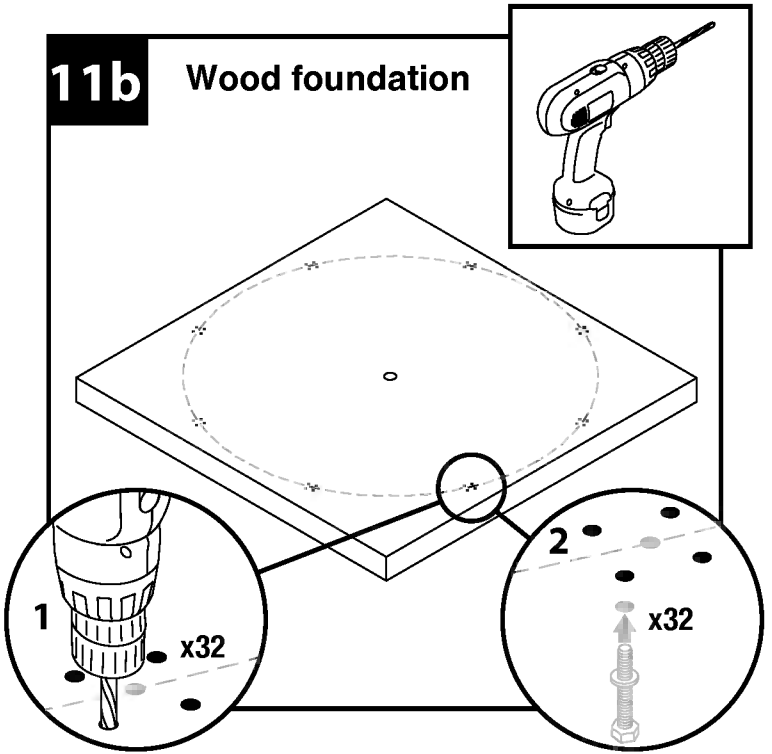
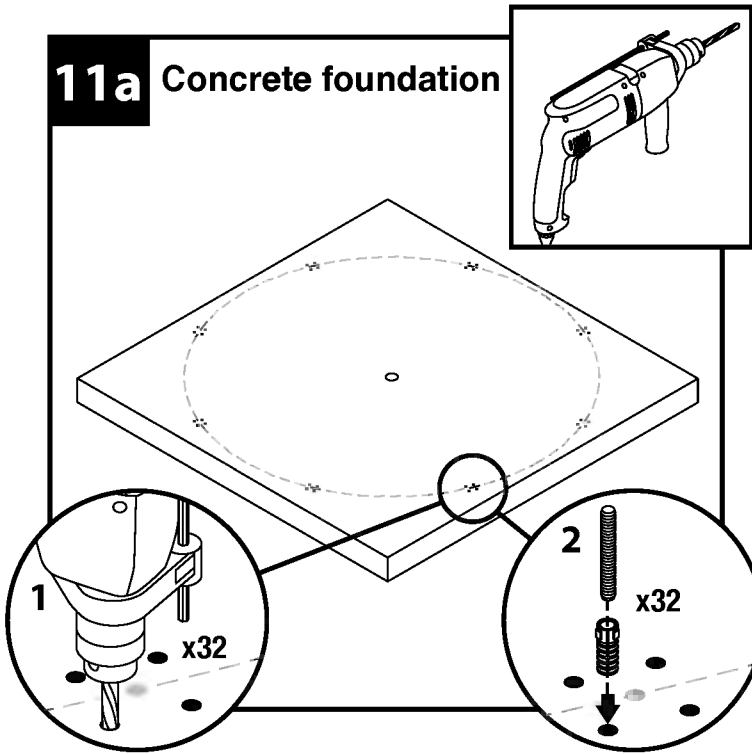

Concrete foundation

Using a standard power drill, drill a small pilot hole half the diameter of your anchor. Using a hammer drill, make holes for each post. Then insert concrete lag anchors and four full-threaded studs.

Wood foundation

Drill holes for each post. From underside of foundation, insert four full-threaded lag bolts and washers.

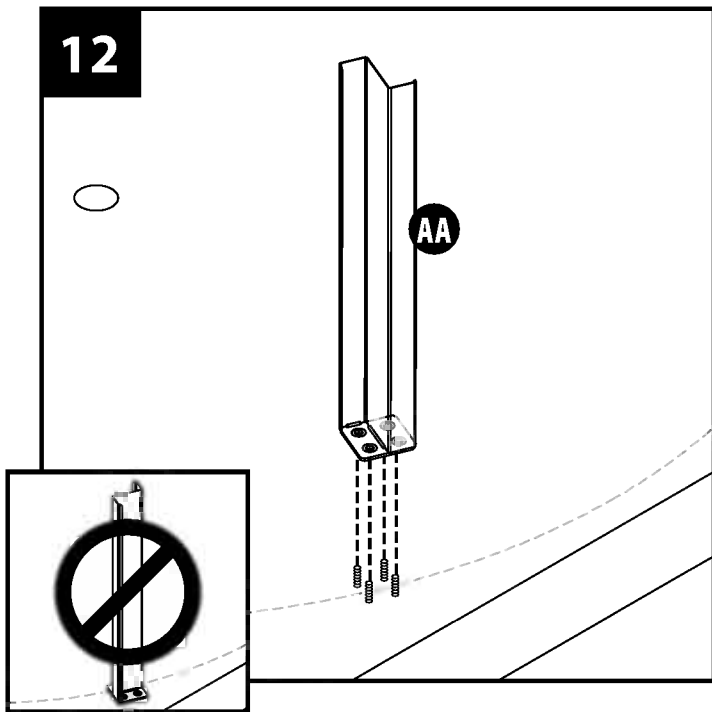

Ensure steel posts are in correct orientation.

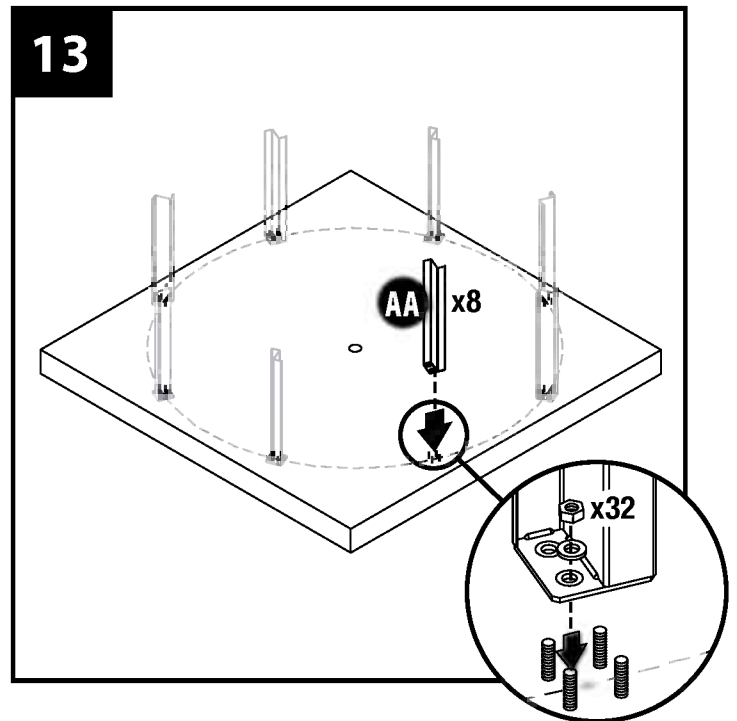

Bolt down all steel posts. **Note:** Ensure all steel posts are secured to foundation.

Parts Pre-Assembly

Note: To avoid scratching finish in steps where parts are placed upside down, place parts on smooth surface. Flatten cardboard from carton to create a smooth surface.

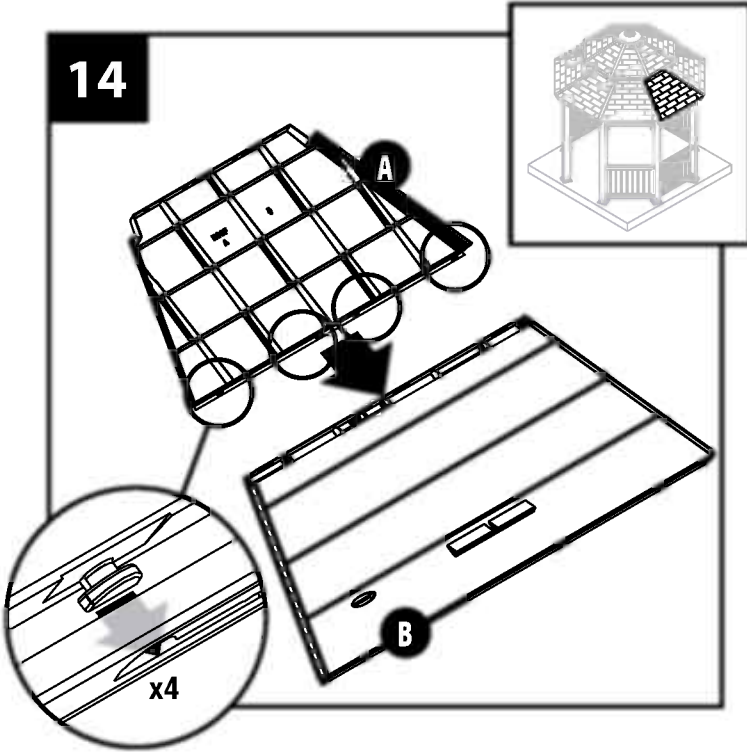

Insert A into the corresponding slots in B.
Note: Ensure that preassembled B is assembled properly.

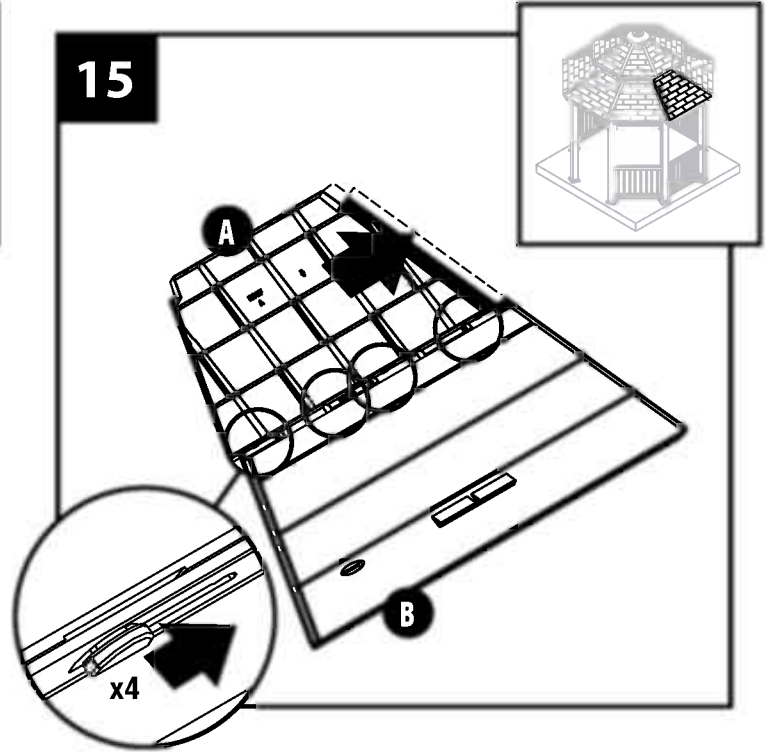

Slide A and lock into place in B.

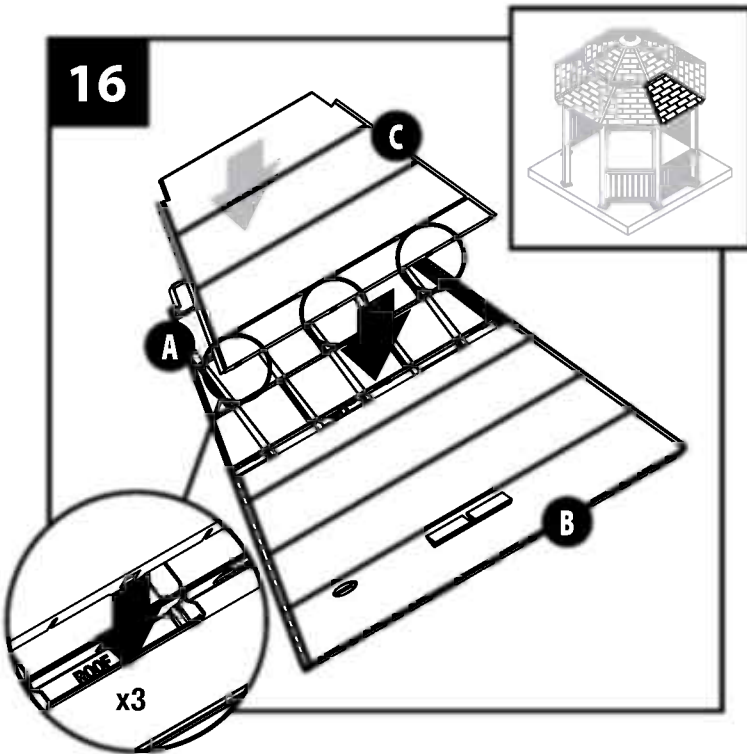

Snap C into A and B to form a single lower roof panel.

17

Repeat steps 14-16 for seven remaining lower roof panels.

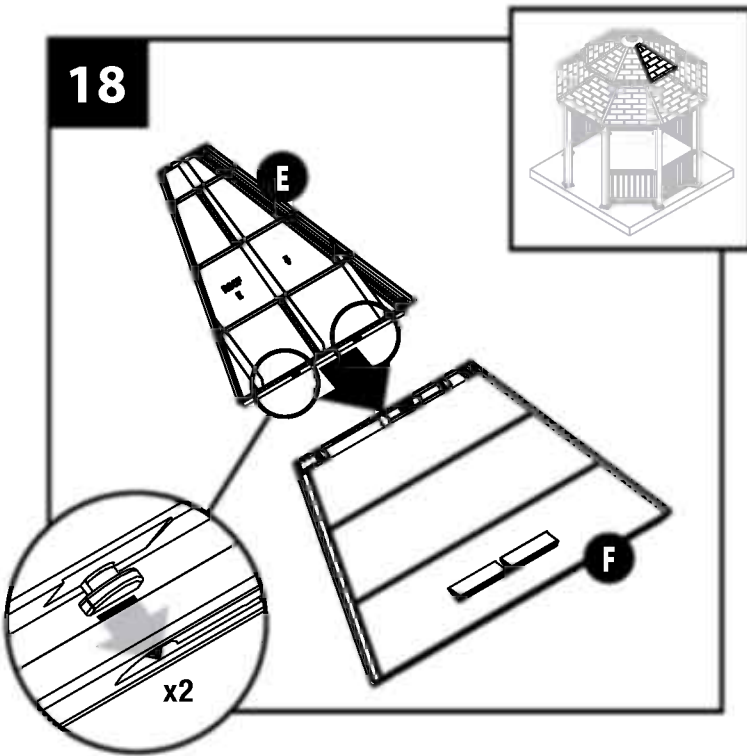

Insert E into the corresponding slots in F.
Note: Ensure preassembled F is assembled properly.

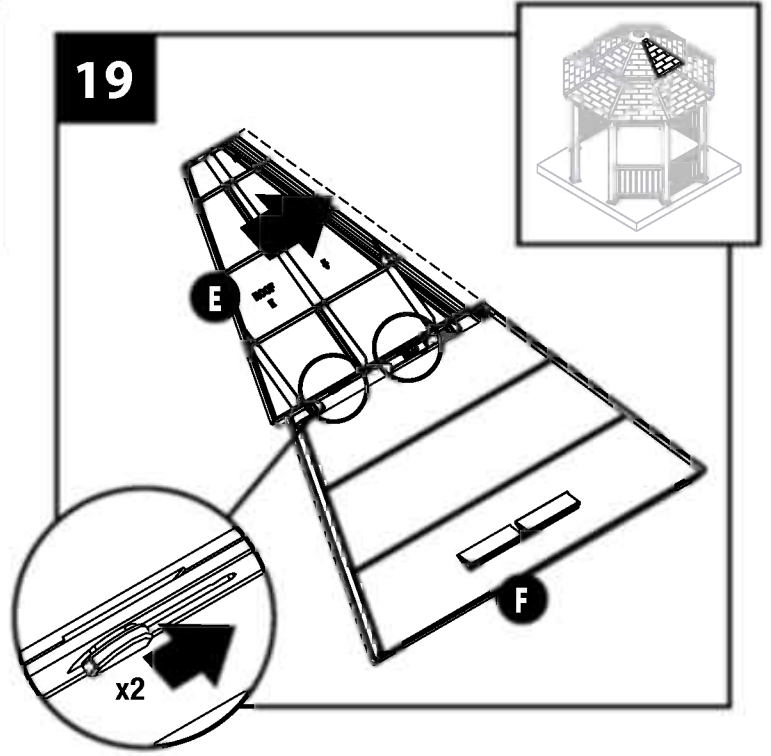

Slide E and lock into place in F.

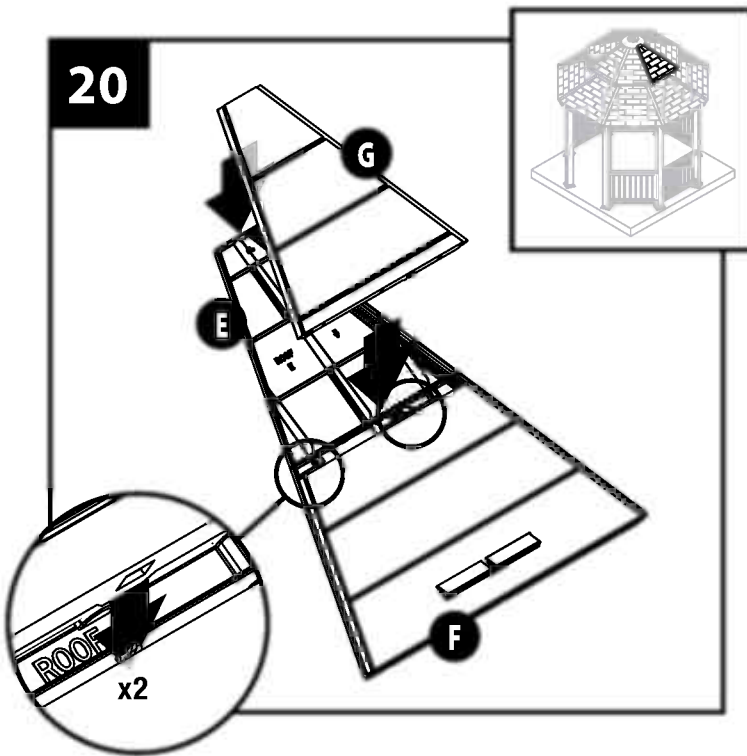

Snap G into E and F to form a single upper roof panel.

21

Repeat steps 18-20 for seven remaining upper roof panels.

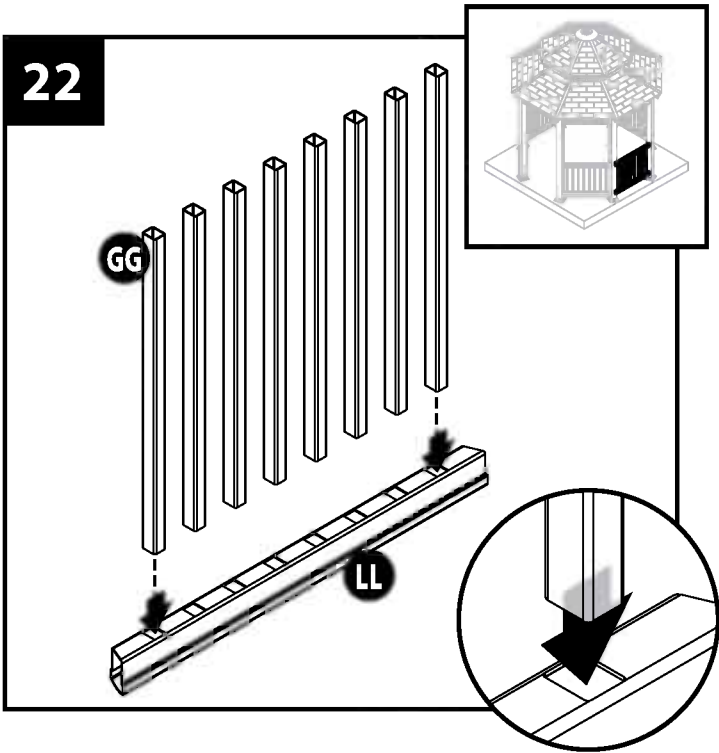

Insert eight hand rail spindles into square hand rail holes.

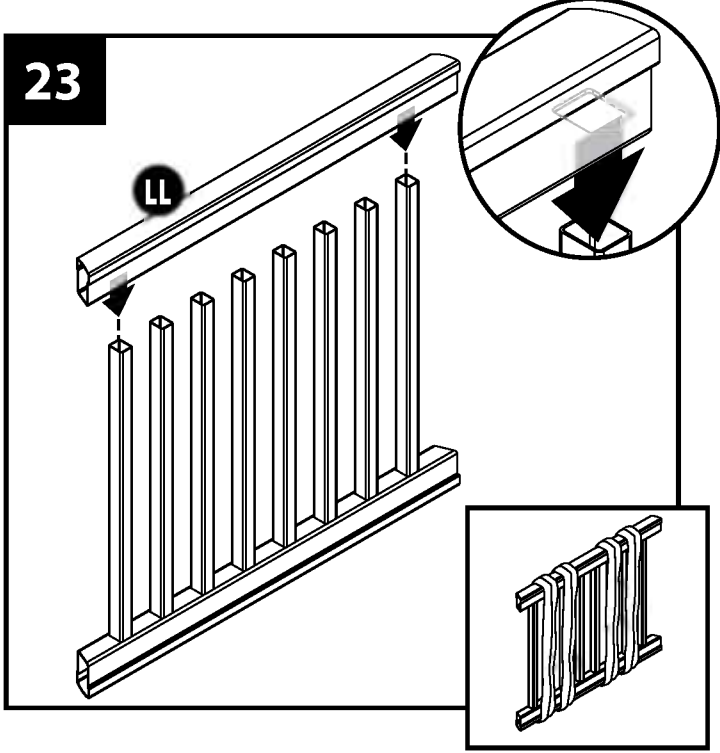

Place another hand rail (matching spindles with square holes). **Optional:** After assembled, run a band of low tack tape around both ends of assembly. This will help hold rails together until they are used again.

24

Repeat steps 22-23 for six remaining hand rails.

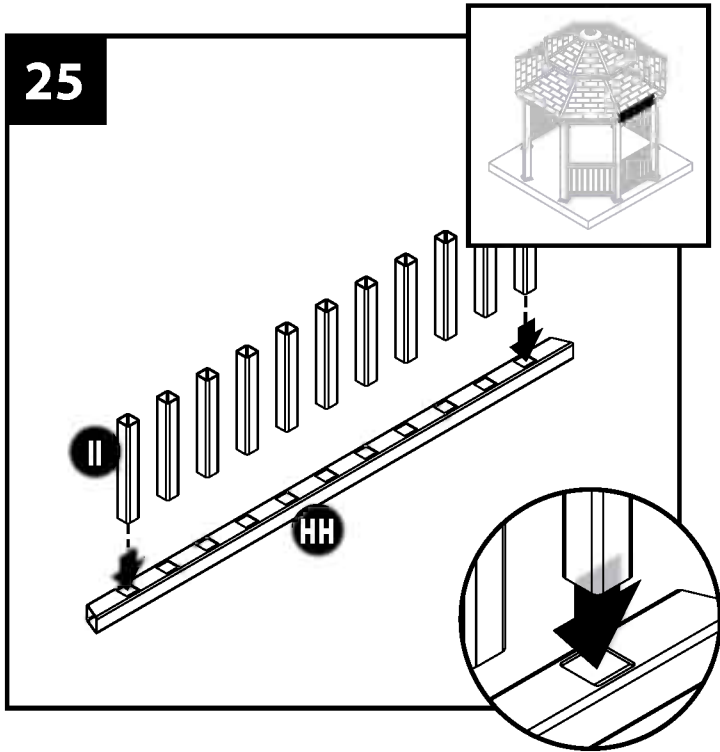

Insert eleven roof spindles into square lower roof rail holes.

26

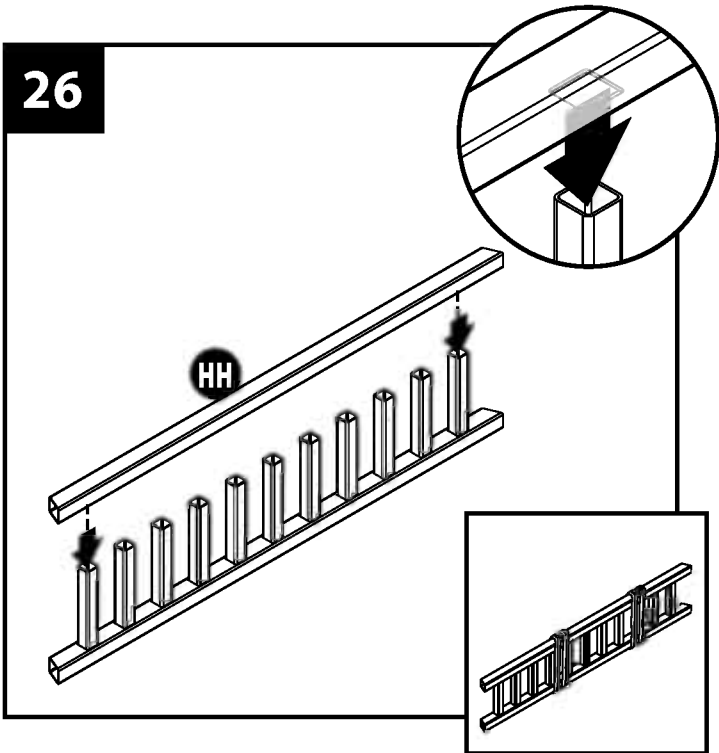

27

Repeat steps 25-26 for seven remaining bottom roof railings.

Place another lower roof rail (matching spindles with square holes). **Note:** Match orientation of bottom of roof rail. **Optional:** After assembled, run a band of low tack tape around both ends of assembly. This will help hold rails together until they are used again.

28

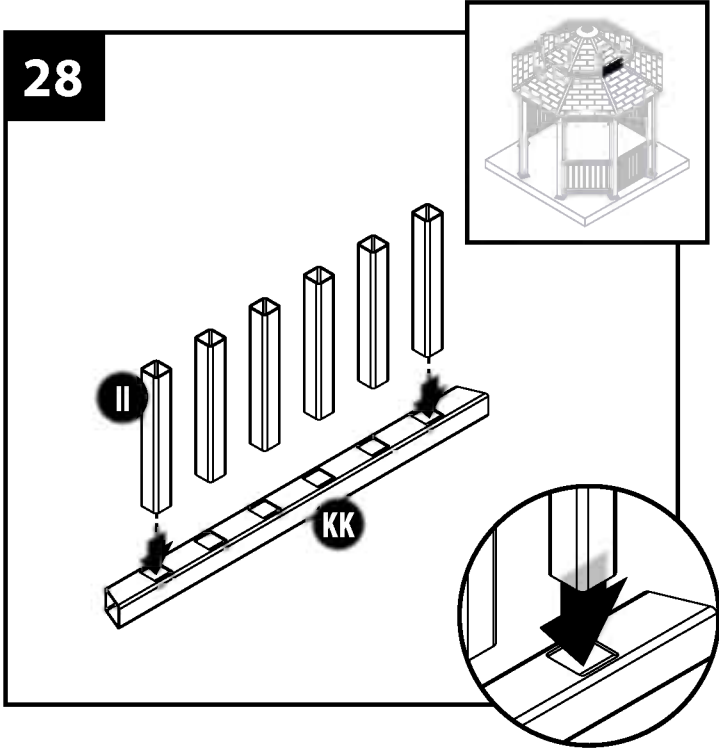

29

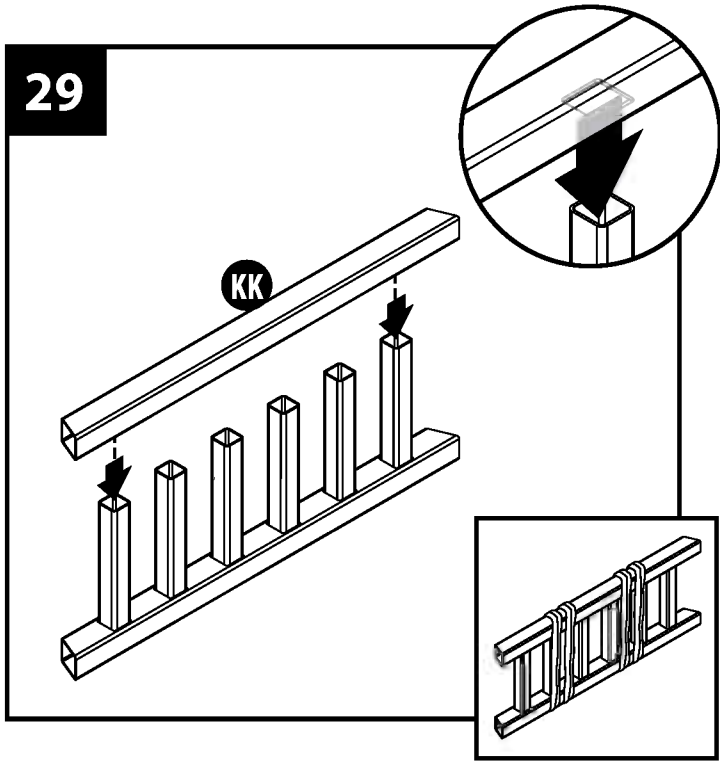

Insert six roof spindles into upper roof rail.

Place another upper roof rail (matching roof spindles with square holes). **Note:** Match orientation of bottom roof rail. **Optional:** After assembled, run a band of low tack tape around both ends of assembly. This will help hold rails together until they are used again.

30

Repeat steps 28-29 for seven remaining upper roof railings.

31

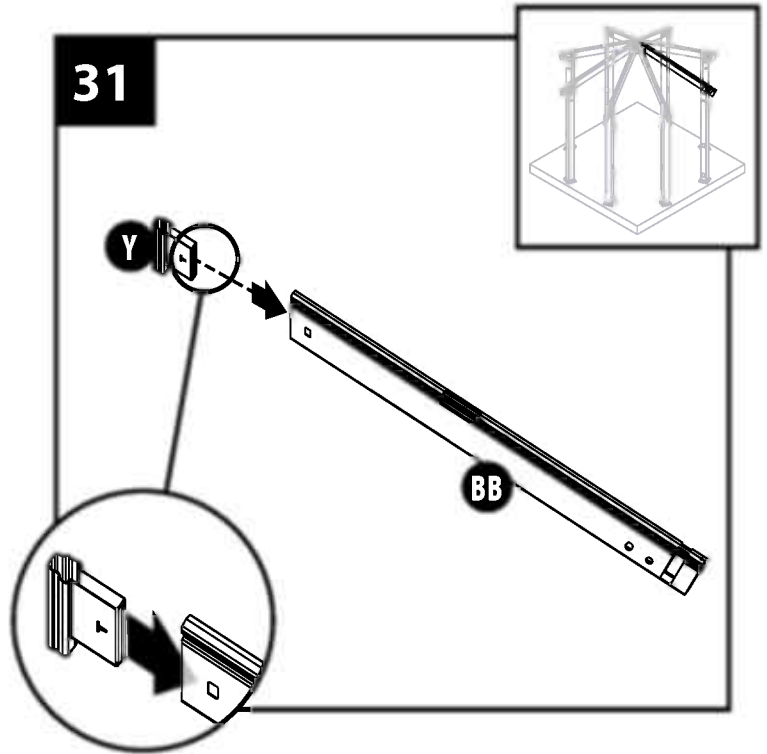

Snap lower rafter hub connector into place at angled end of lower roof rafter.

32

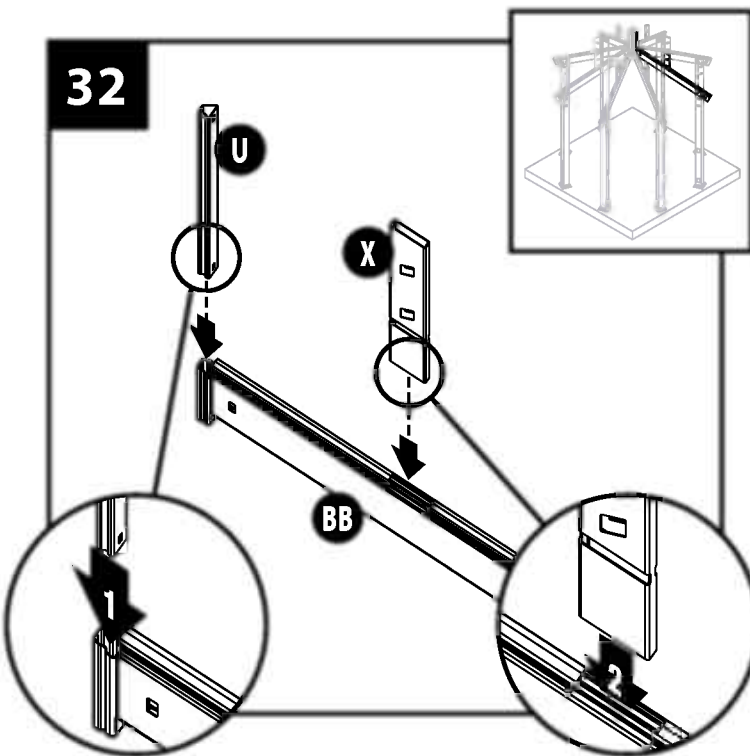

Snap center hub spacer into lower roof rafter hub connector. Add roof support post to lower roof rafter.

33

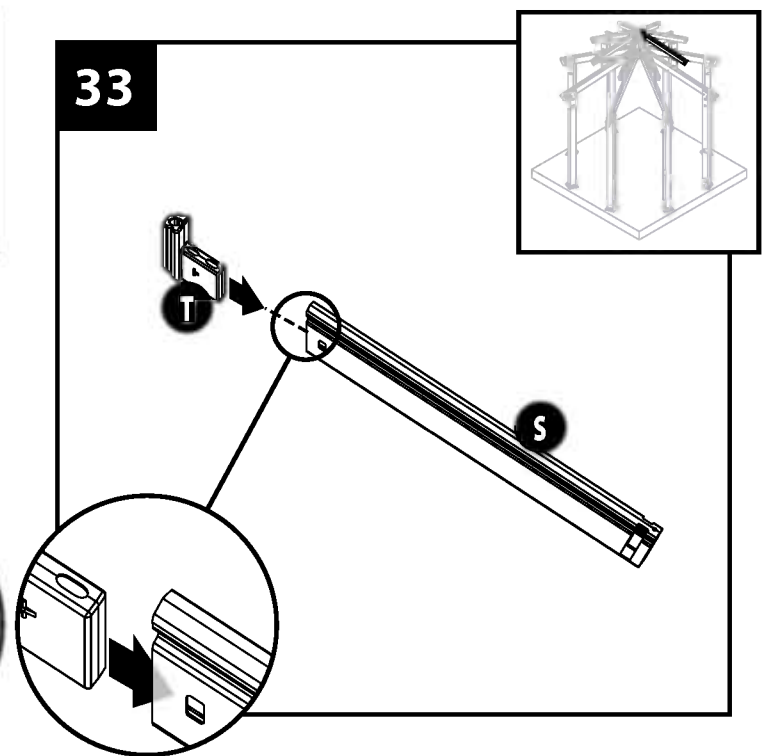

Snap upper rafter connector into place on angled side of upper roof rafter.

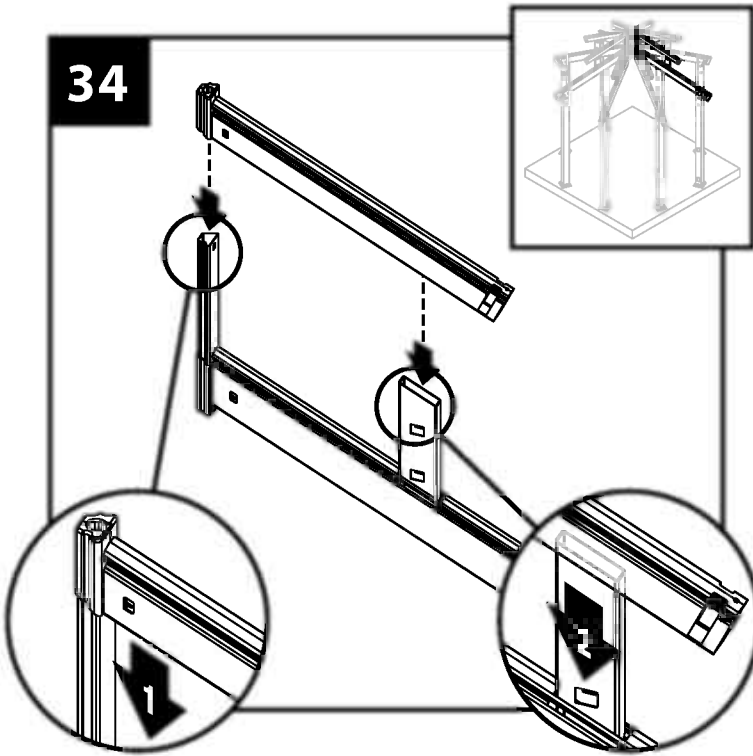

34 Snap upper rafter connector onto center hub spacer. Slide upper roof rafter into place over roof support post on lower roof rafter.

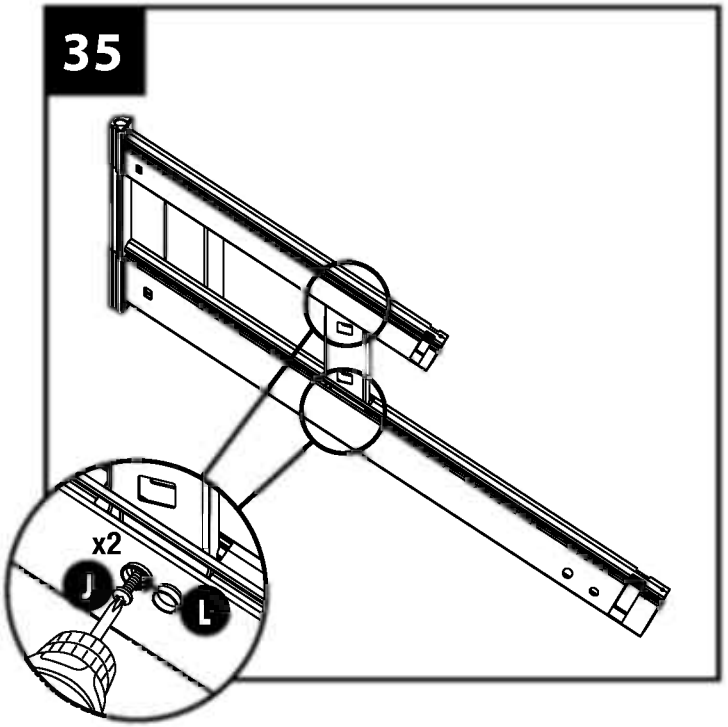

35 Secure roof support posts to upper and lower roof rafters using screws and screw caps.
Note: Make sure screw goes into the roof support post.

36

Repeat steps 31-35 for seven remaining roof rafters.

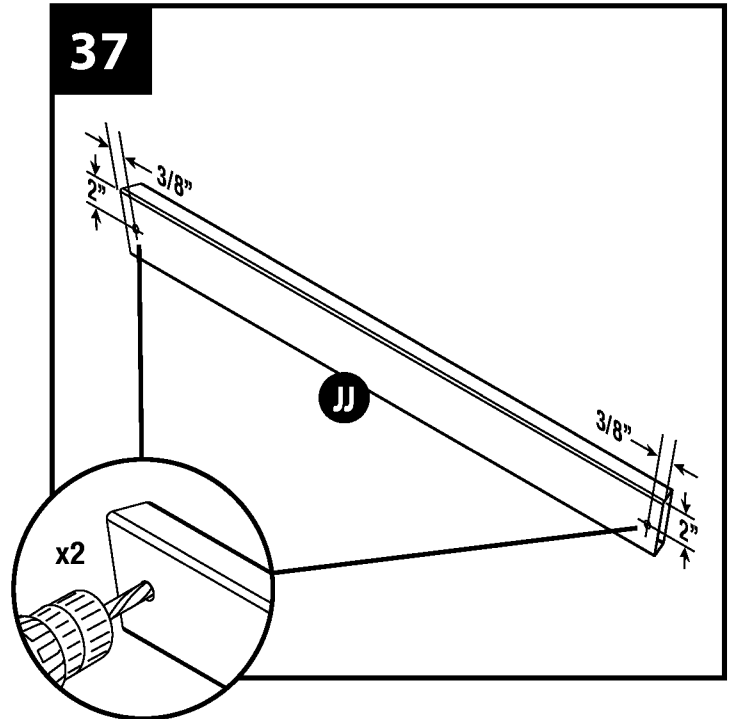

37 Pre-drill two 1/8" holes into lower roof fascia.
Note: Make sure to drill into the front face of the fascia (largest surface).

38

Repeat step 37
for seven remaining
lower roof fascia.

39

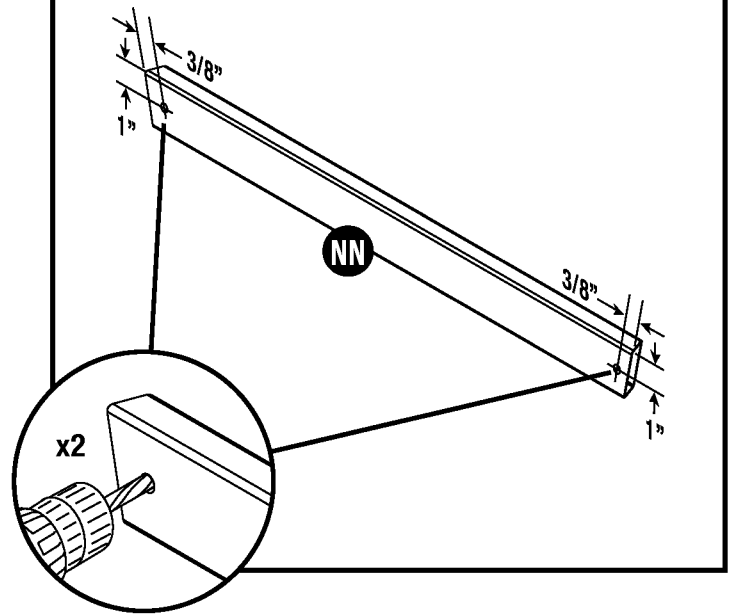

Pre-drill two 1/8" holes into upper roof fascia.
Note: Make sure to drill into the front face of the
fascia (largest surface).

40

Repeat step 39
for seven remaining
upper roof fascia.

Parts pre-assembly has
now been completed.
Before starting gazebo
assembly, allow
adequate time (about 6
hours). Some steps will
require more than one
person to complete.

Gazebo Assembly

Note: Verify post assembly orientation (see Step 12).

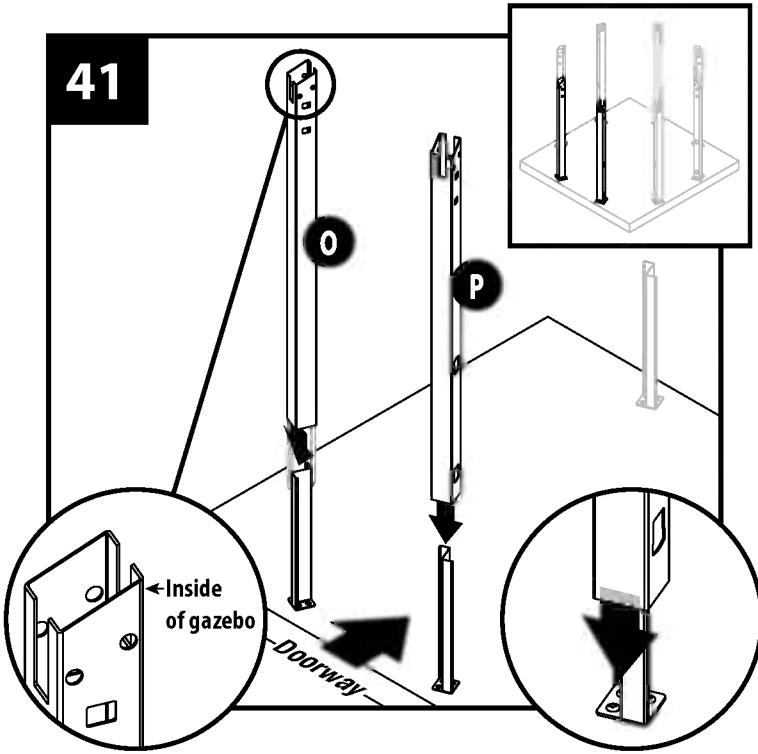

Place left and right doorway posts over steel posts, making sure that hand rail holes face away from doorway.

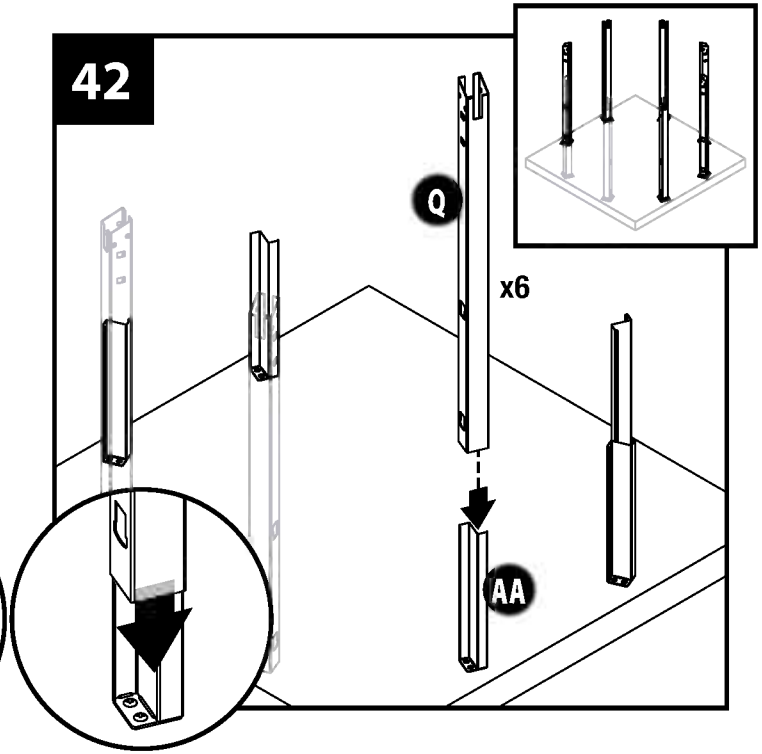

Place the six remaining posts over remaining steel posts.

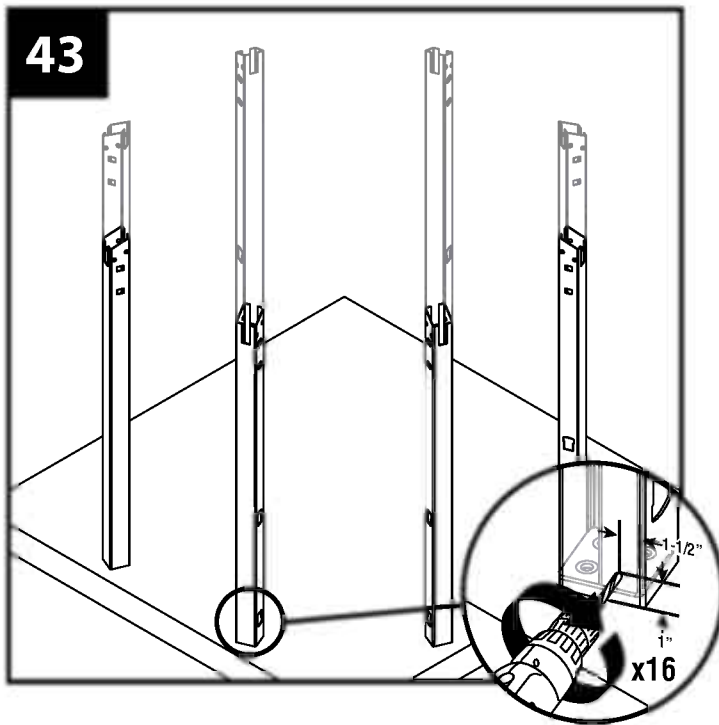

Predrill two 1/8" holes through each of the eight posts and into steel posts (both flat sides of steel posts). Make sure to note the "Z" shape of steel post when drilling hole on opposite side of posts.

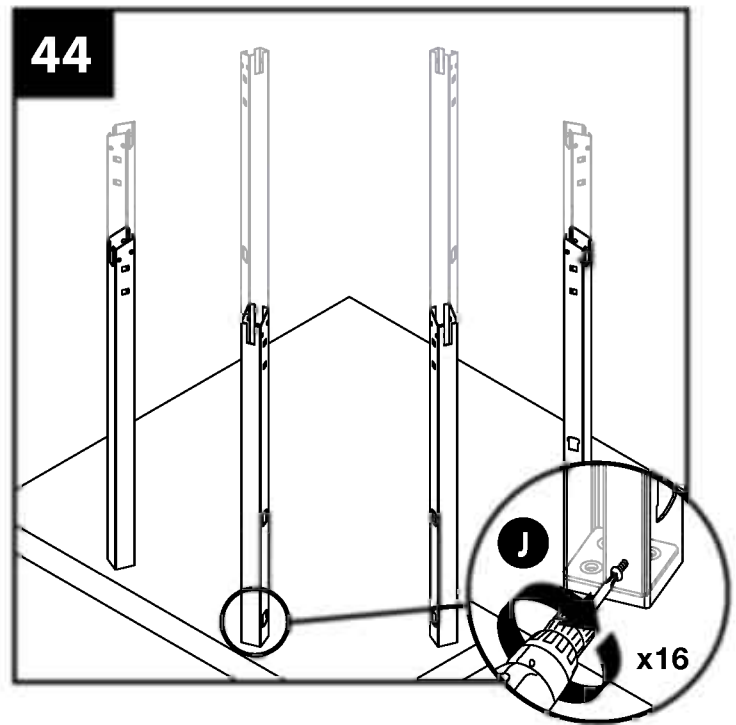

Secure all posts with screws in pilot holes.

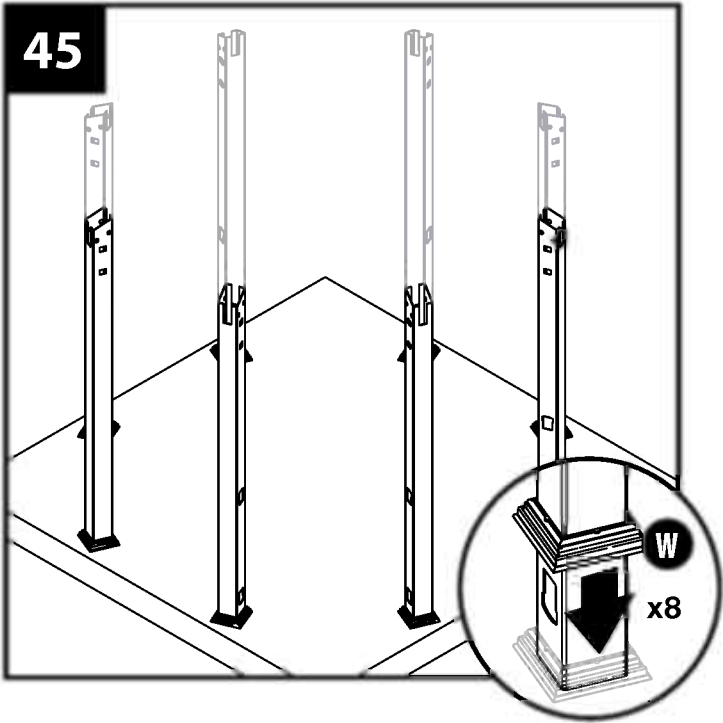

Slide one post collar over each post.

46

For steps 47-52 have one person stand on an 8' ladder in the middle of foundation and another person on a 6' ladder next to the post you are working with. The extra height will make it easier to assemble parts.

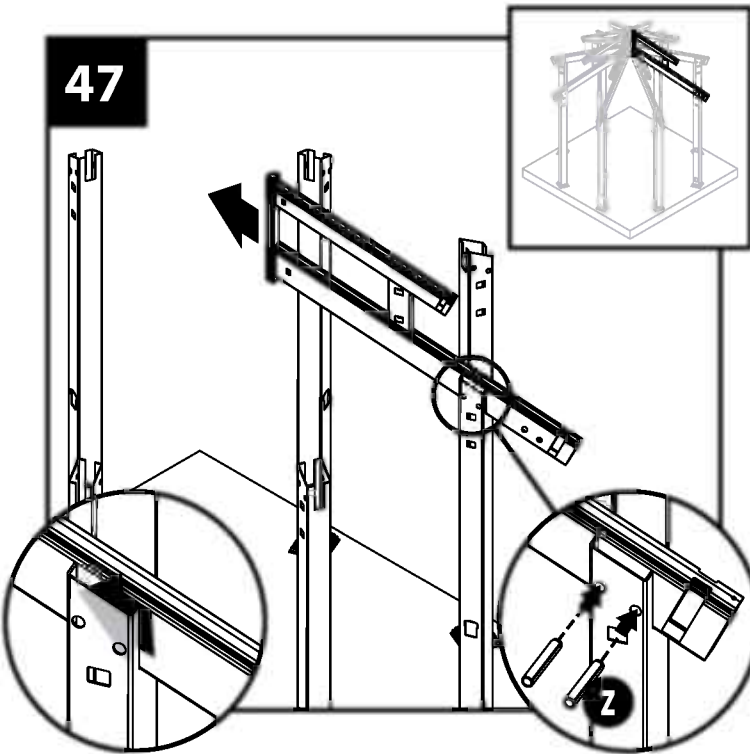

Slide one rafter assembly up through post notch and into position. Secure with two dowel pins. Make sure that dowel pin slit is facing away from center of gazebo. (If necessary, use a rubber mallet to ensure tips of dowel pins exit other side of post.) The person on 8' ladder will need to support rafter assembly.

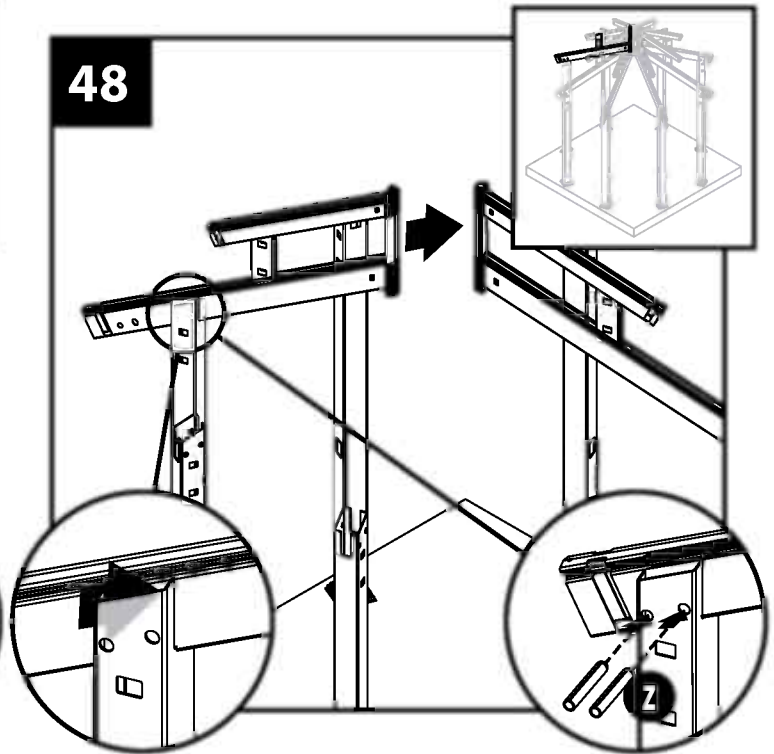

Slide opposite rafter assembly up through post notch and into position. Secure with two dowel pins. Make sure that dowel pin slit is facing away from center of gazebo. (If necessary, use a rubber mallet to ensure tips of dowel pins exit other side of post.) Make sure to support rafters after assembling.

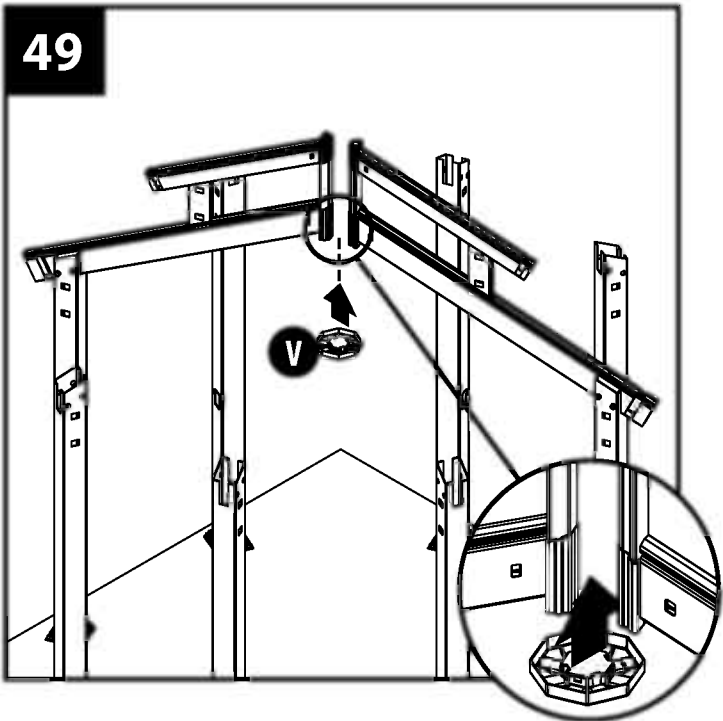

Snap bottom hub connector onto rafter connectors, making sure to insert the first rafter connections into the smaller snap holes in bottom hub connector.
Note: The hub connector will only engage on alternating rafter assemblies. **DO NOT** remove sticker from center of bottom hub connector at this time.

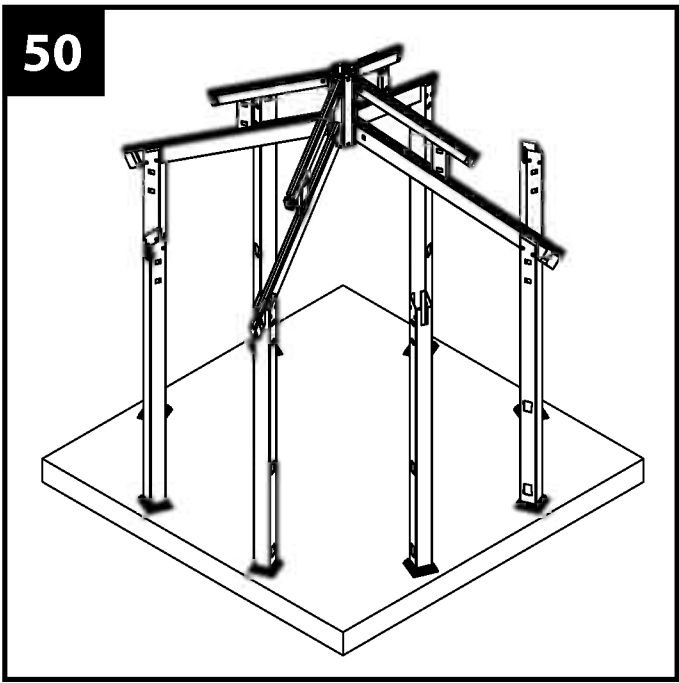

Repeat steps 44-46 for two perpendicular rafter assemblies.

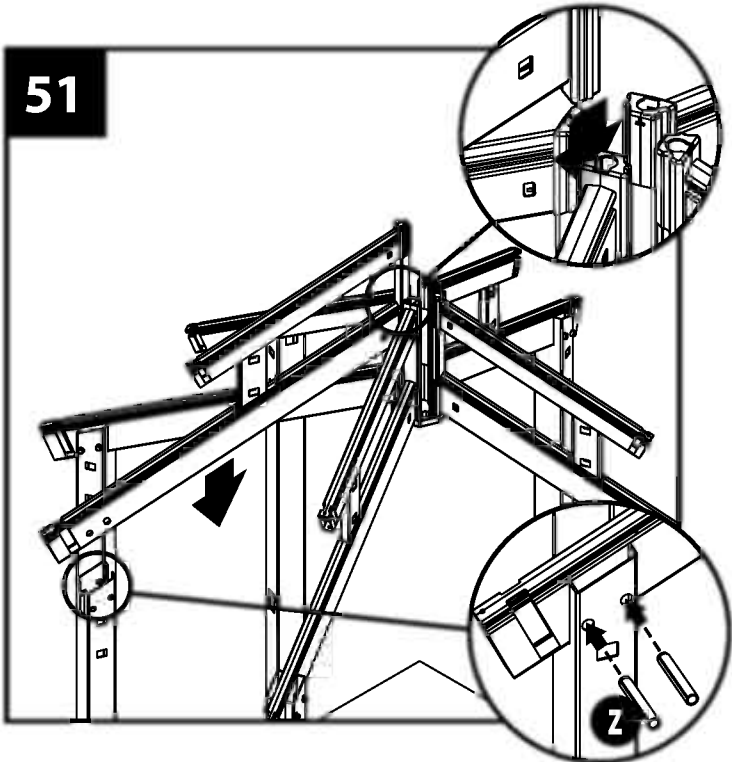

Lift fifth rafter assembly 6" above installed rafters. Slide connector down into place along grooves. Secure lower end of rafter with two dowel pins. Make sure that dowel pin slit is facing away from center of gazebo. (If necessary, use a rubber mallet to ensure tips of pins exit other side of post).

52

Repeat step 51 for remaining three rafter assemblies.

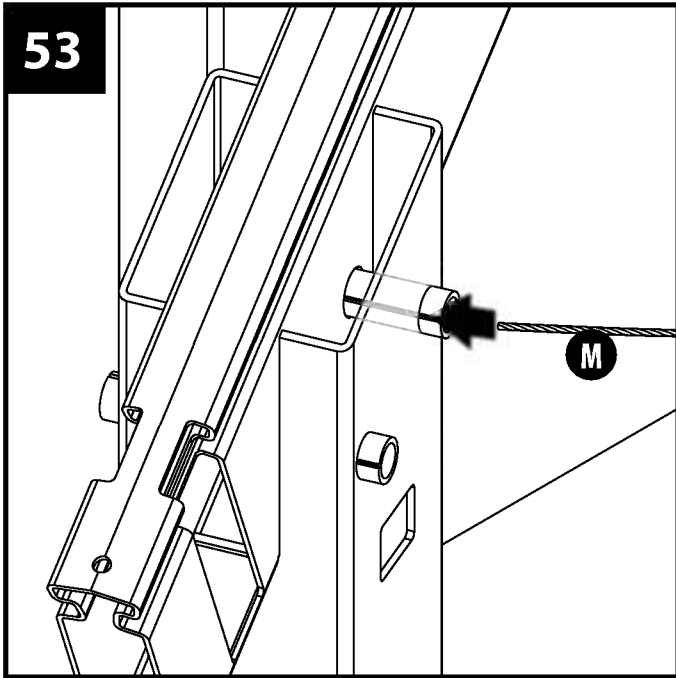

Thread turnbuckle cable through one upper, inner most dowl pin.

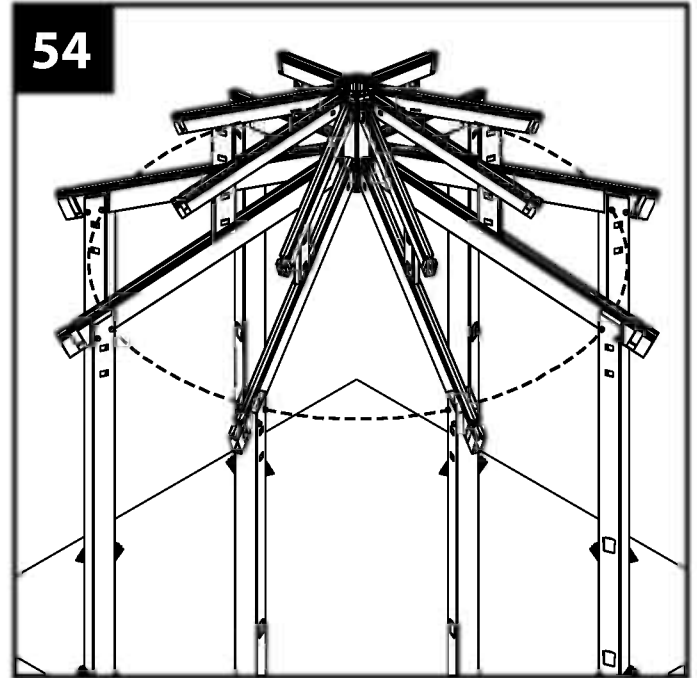

Continue to thread turnbuckle cable through upper, inner most dowl pins, between posts and rafters (to stabilize assembly). When threading turnbuckle cable, make sure dowl pins stay in position. If dowl pins do move out of position, tap them back into place using a rubber mallet.

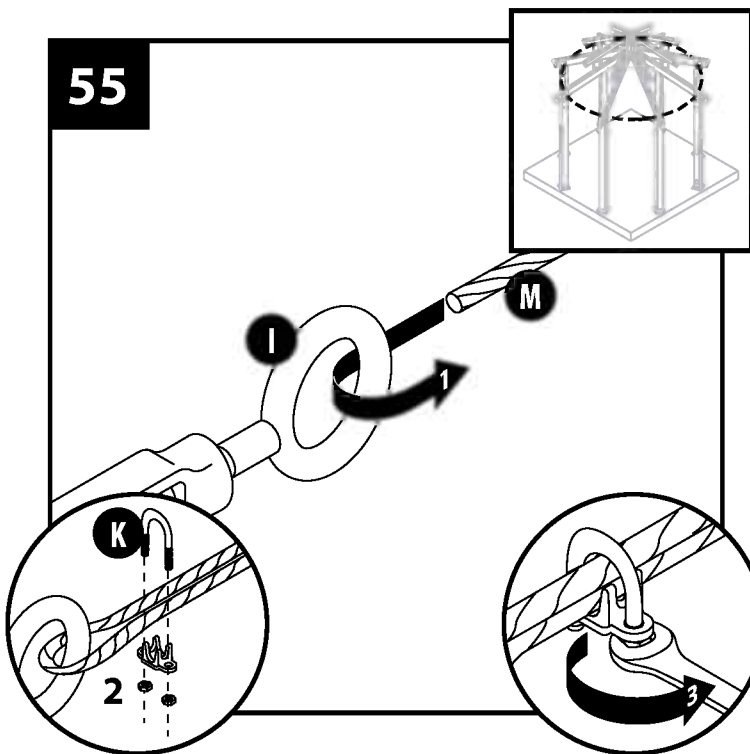

Loop cable through turnbuckle eyelet. Put clamp on cable. Use wrench to tighten nuts.

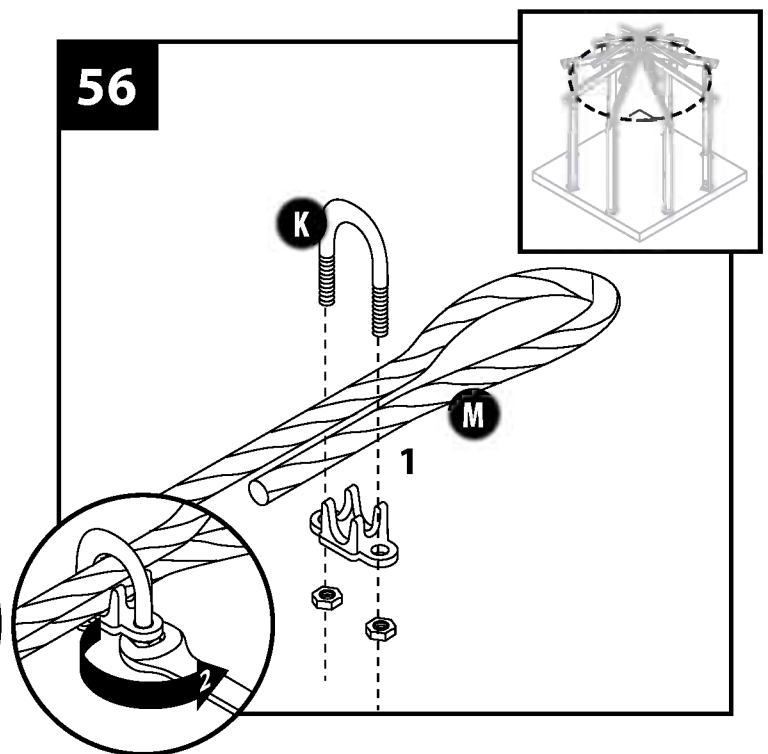

Put clamp on remaining end of cable. Use wrench to tighten nuts. There will be excess cable. **DO NOT** remove excess cable at this time.

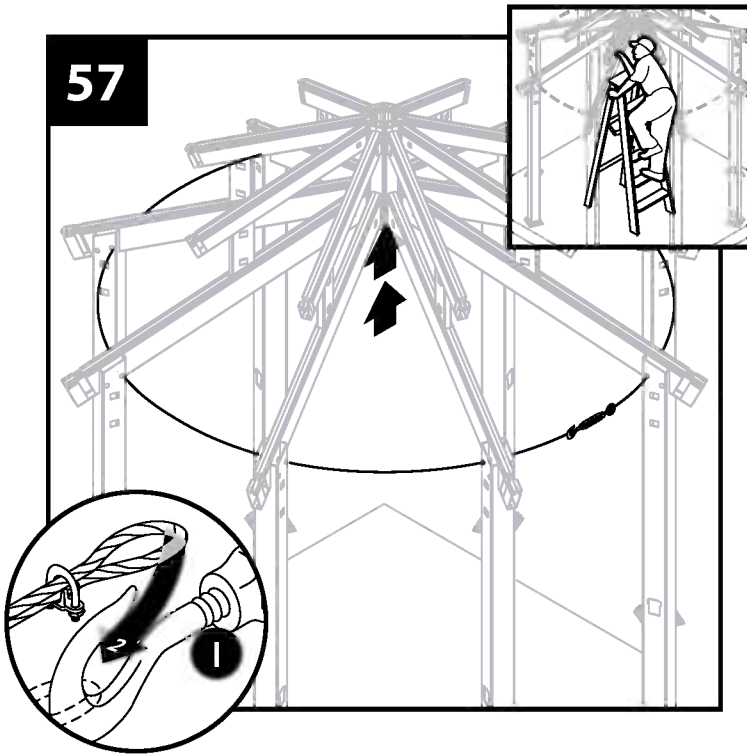

57
Position one person on ladder at center of gazebo. This person is to push upwards on bottom hub connector and hold it in an elevated position while the second person places looped cable end over turnbuckle hook.

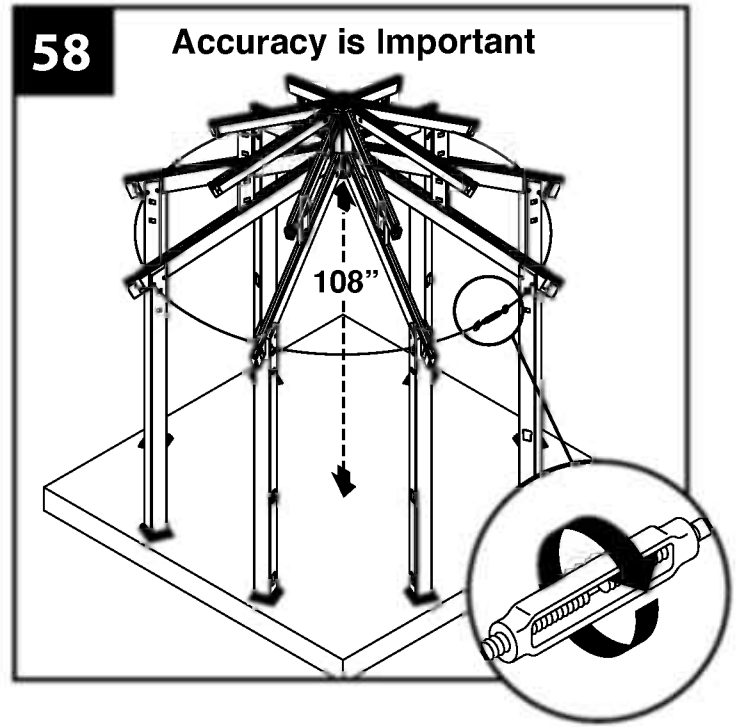

58 Accuracy is Important
Check that the distance from the sticker on the center of the bottom hub connector to the floor is 108". If distance is not 108" adjust the turnbuckle until it is. When adjusting the turnbuckle make sure that the dowels stay in position. If dowel pins do move out of position, tap them back into place using a rubber mallet.

If the 108" measurement is not achievable by adjusting the turnbuckle, position one person on a ladder at center of gazebo to push up on bottom hub connector and hold it in an elevated position while a second person loosens and relocates the clamps on the cable achieve for the 108" measurement.

The 108" measurement must be achieved by the tension of the cable alone **WITHOUT** anyone holding the bottom hub connector in the elevated position. This is important for ensuring roof panels fit properly in the following steps.

Repeat this process until the 108" measurement is achieved.

DO NOT proceed to next step without achieving the 108" measurement.

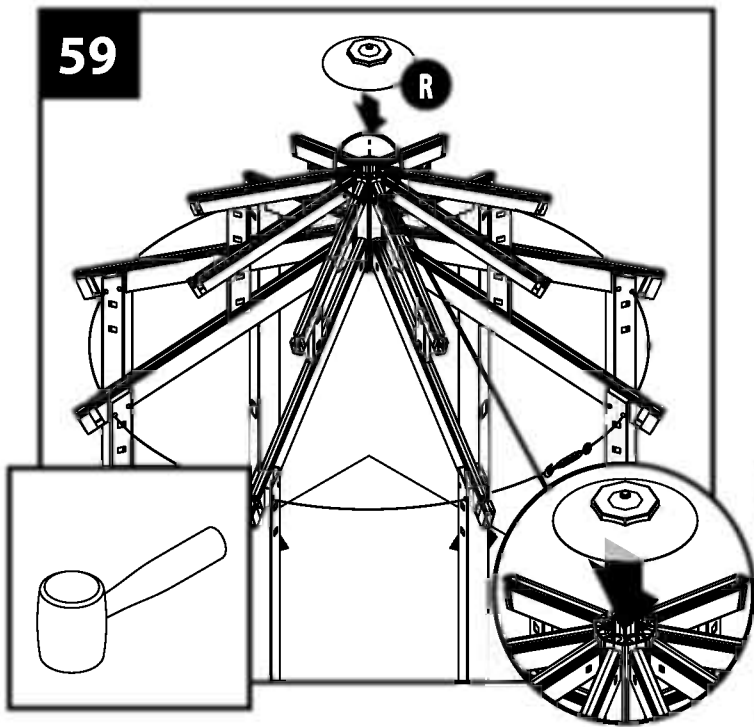

Using a rubber mallet, attach top cap onto upper roof rafter connectors.

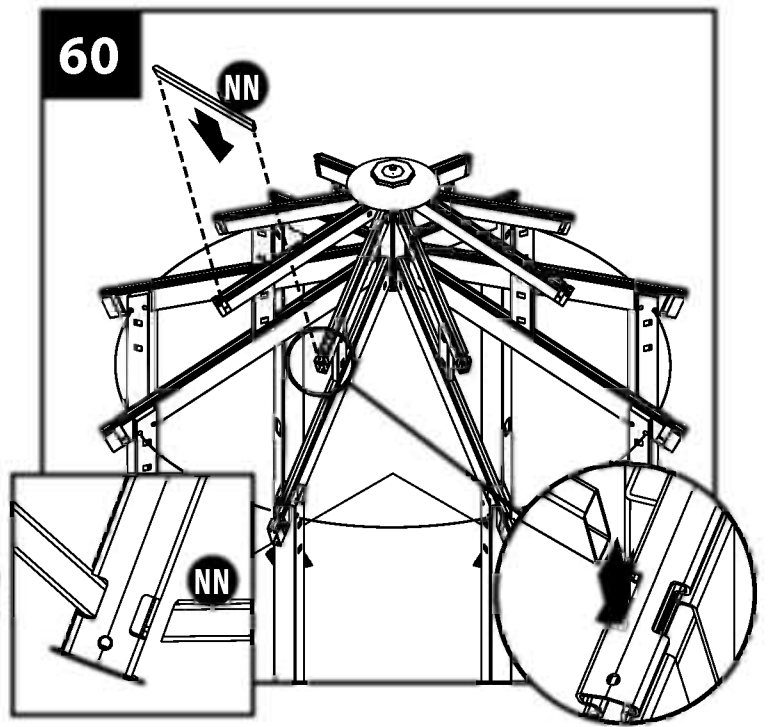

Insert one upper roof fascia board between upper roof rafters. Make sure longer side of roof fascia board is facing front.

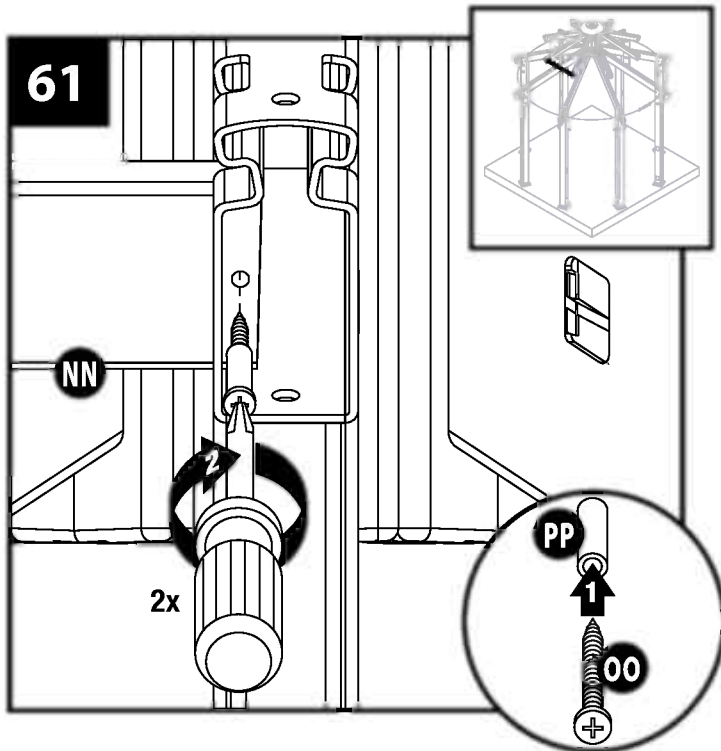

Place one nylon spacer over one screw. Looking inside the open end of the rafter, locate the predrilled hole in the upper roof fascia. Using a manual philips head screwdriver, screw the screw into predrilled holes in upper roof fascia. Repeat process for second hole in opposite side of upper roof fascia.

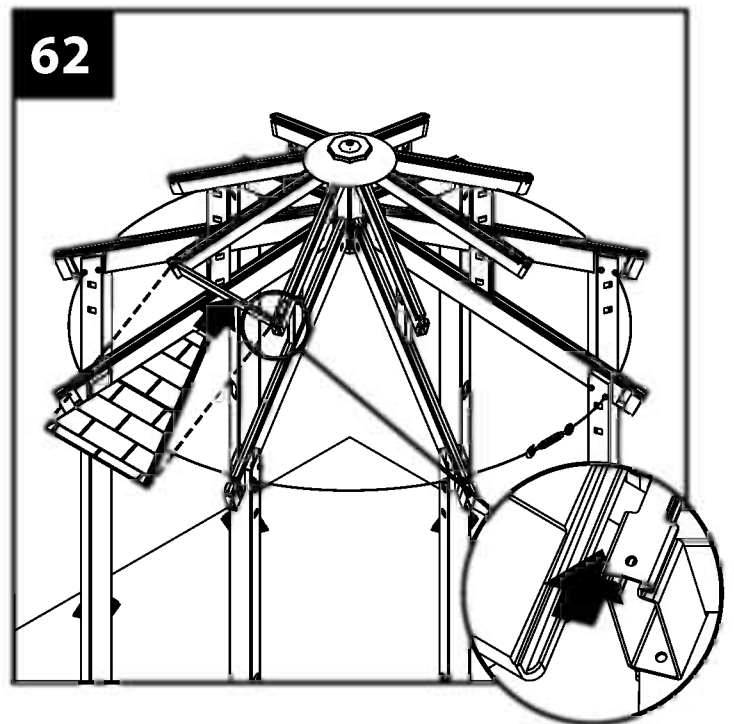

Take one pre-assembled upper roof panel and slide over fascia boards along rafter groove and under top cap. Make sure roof panel is fully engaged on inside of fascia boards.

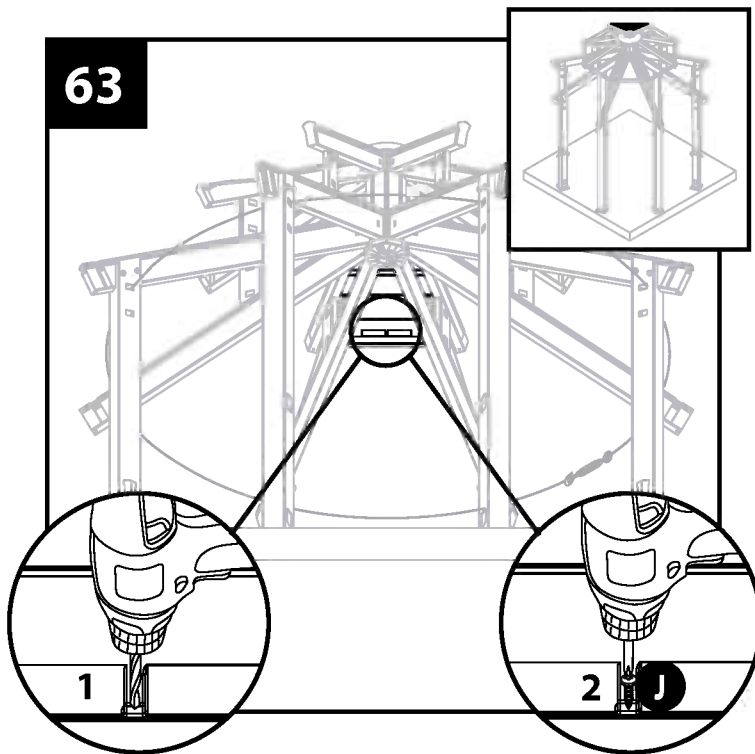

Ensure fascia board is centered between rafters and predrill 1/8" hole. Apply light pressure to top of roof panel and secure upper roof panel to fascia board with screw.

64

Repeat steps 60-63 for remaining seven top roof fascia boards.

DO NOT proceed to next step until step 64 is complete.

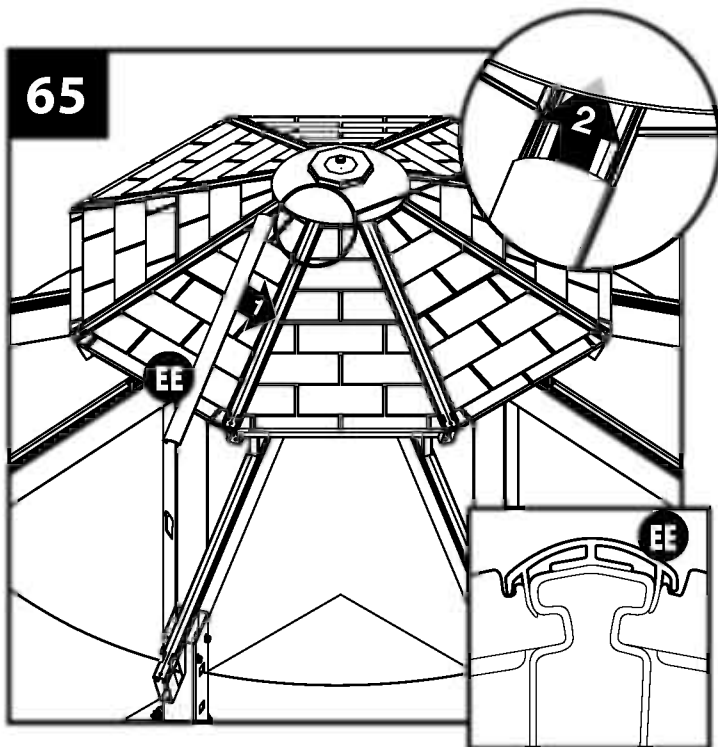

Position one roof weather strip 3/4 of the way up on upper roof rafter so it extends past mid-roof seam and press down into place. Slide up under top cap until flush with end of upper roof rafters. Make sure that sides of weather strip wrap around rafter and into channels of roof panels. If necessary use a rubber mallet to tap weather strip flush to end of rafter.

66

Repeat step 65 for remaining seven weather strips.

Repeat step 58 to verify 108" measurement. Measurement is critical for proper roof panel fit. Adjust cable if necessary.

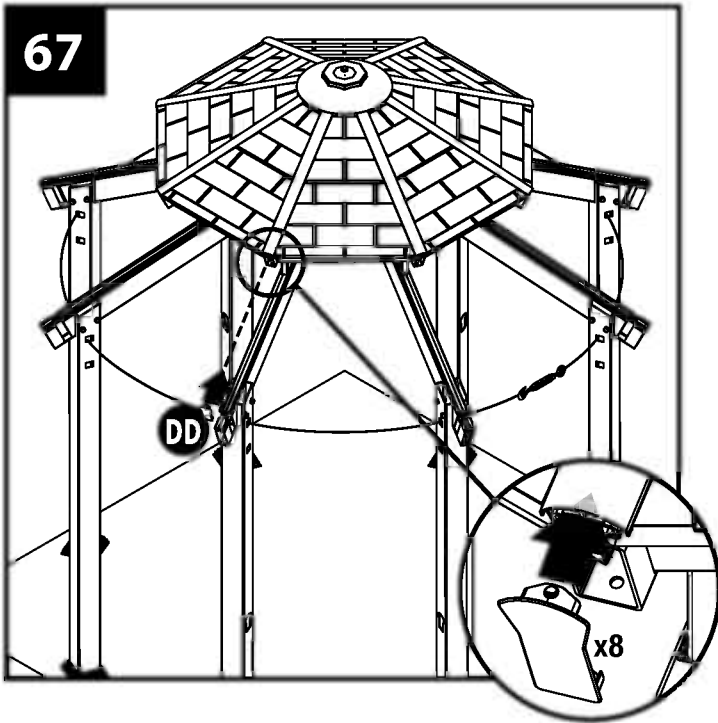

Snap one upper roof end cap onto end of each upper roof rafter.

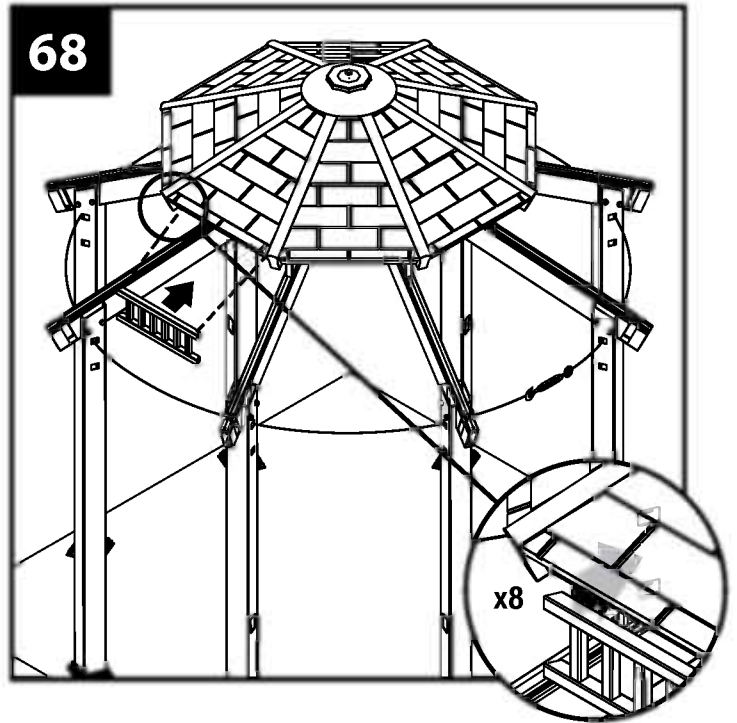

Insert one pre-assembled upper roof railing between roof support posts. (Ensure rails are centered.)

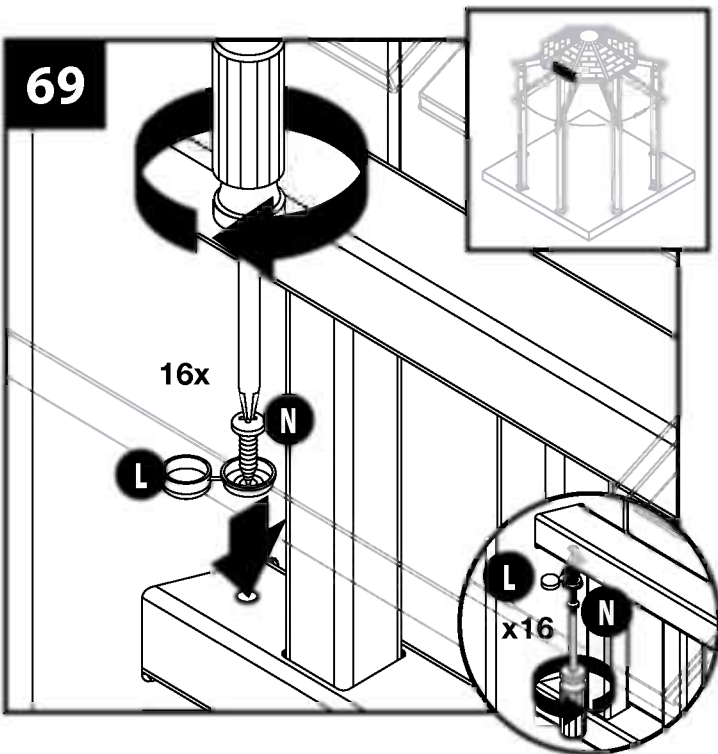

Insert flathead screw through cap and screw into pre-drilled holes (top and bottom) of upper roof railings (four per rail).

70

Repeat steps 68-69 for remaining seven upper roof railings.

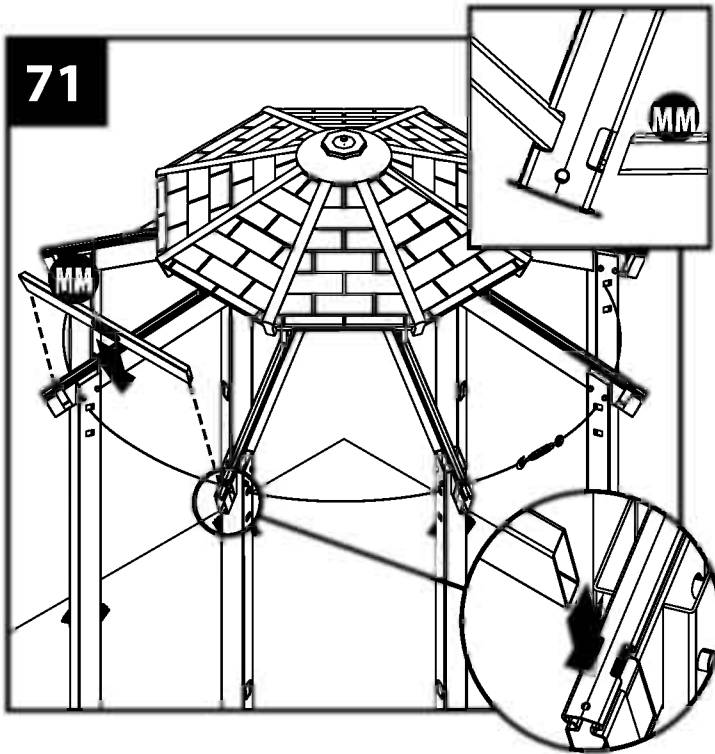

Insert doorway lower roof fascia board into place between doorway posts.

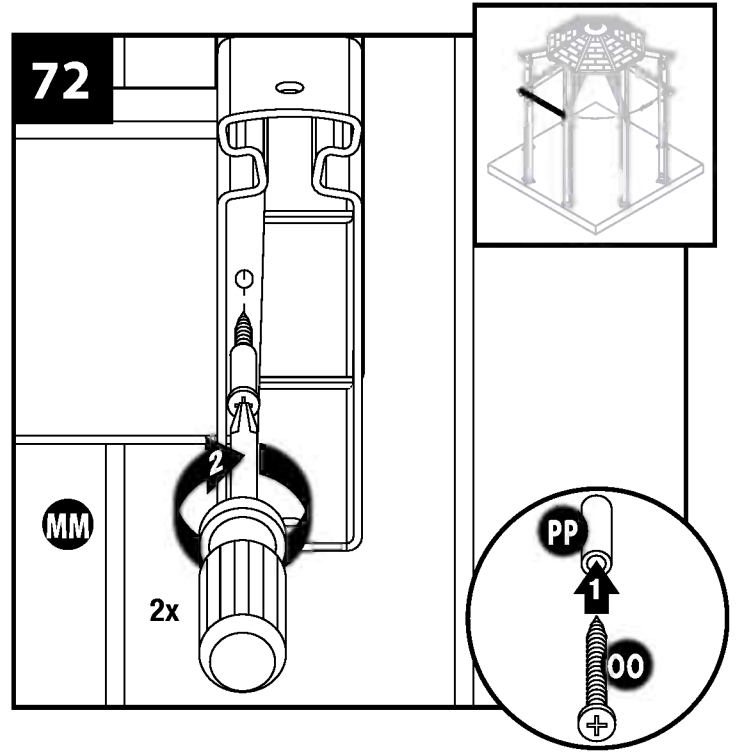

Place one nylon spacer over one screw. Looking inside the open end of the rafter, locate the predrilled hole in the lower roof fascia. Using a manual philips head screwdriver, screw the screw into predrilled holes in upper roof fascia. Repeat process for second hole in opposite side of lower roof fascia.

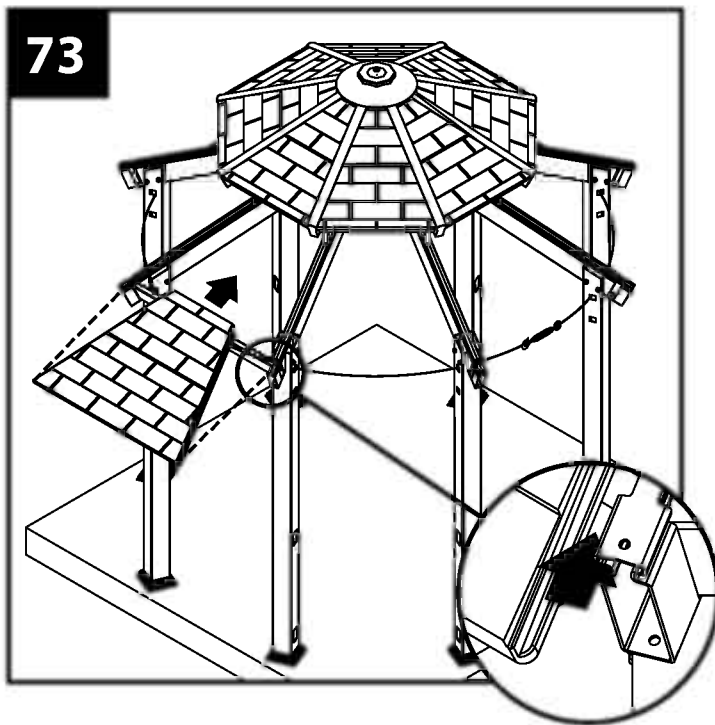

Take one pre-assembled lower roof panel and slide over lower fascia board along the rafter groove. Make sure lower roof panel is fully engaged on inside of lower fascia boards. The tab on the underside of the roof panel must slide over and inside the fascia.

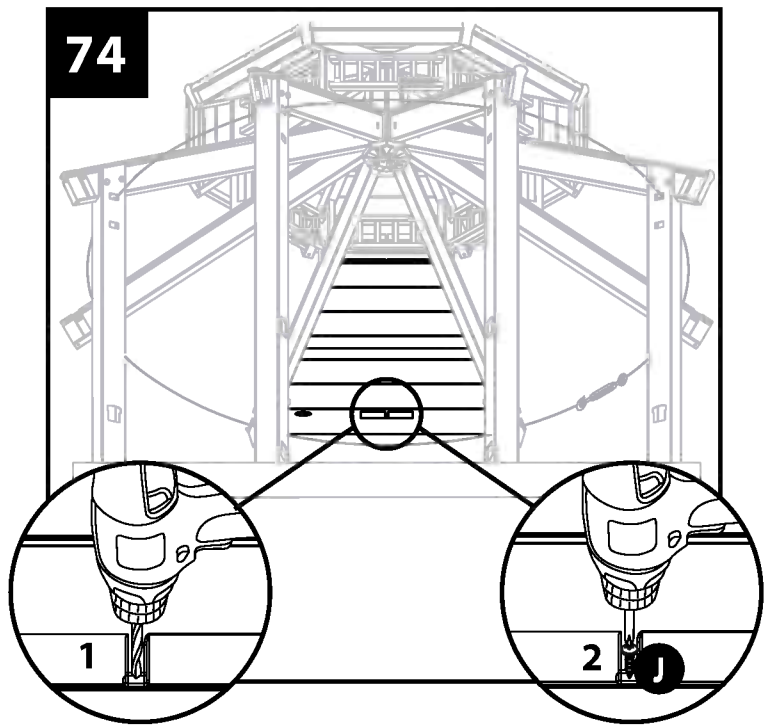

Ensure fascia board is centered between rafters and predrill 1/8" hole. Apply light pressure to top of roof panel and secure lower roof panel to lower roof fascia board with screw.

75

Repeat steps 71-74 for remaining seven lower roof fascia boards and lower roof panels.

If rafter opening is too tight for last roof panel to be inserted - **DO NOT** force in place. Loosen turnbuckle slightly to allow final panel to be inserted.

If rafter opening is too wide for last roof panel to be inserted, tighten turnbuckle to allow final panel to be inserted.

When all lower roof fascia boards and lower roof panels are in place repeat Step 58 to verify 108" measurement.

76

DO NOT proceed to next step until step 75 is complete.

77

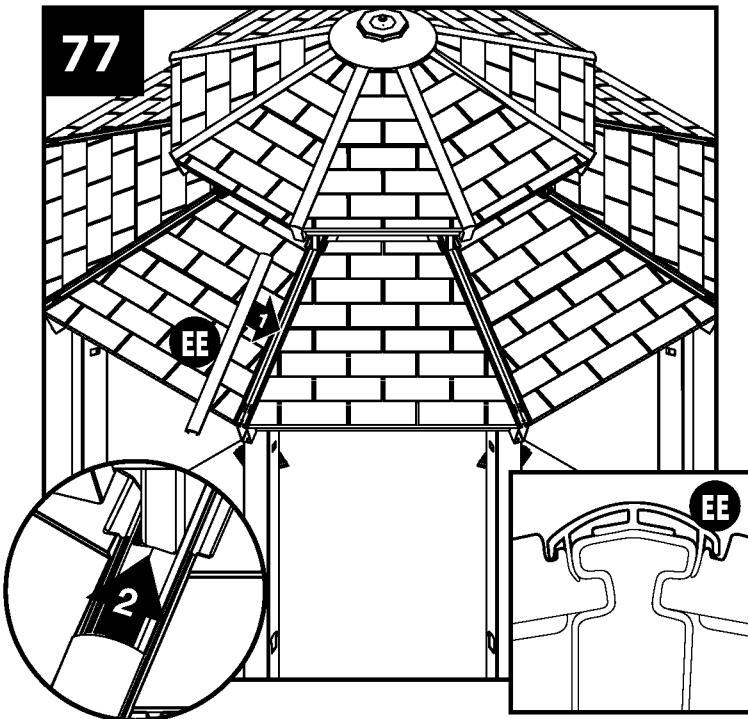

78

Repeat step 77 for remaining seven weather strips.

Position one roof weather strip 3/4 of the way up on lower roof rafter so it extends past mid-roof seam and press down into place. Slide up until flush with end of upper roof rafter. Make sure that sides of weather strip wrap around rafter and into channels of roof panels. If necessary, use rubber mallet to tap weather strip flush to end of rafter.

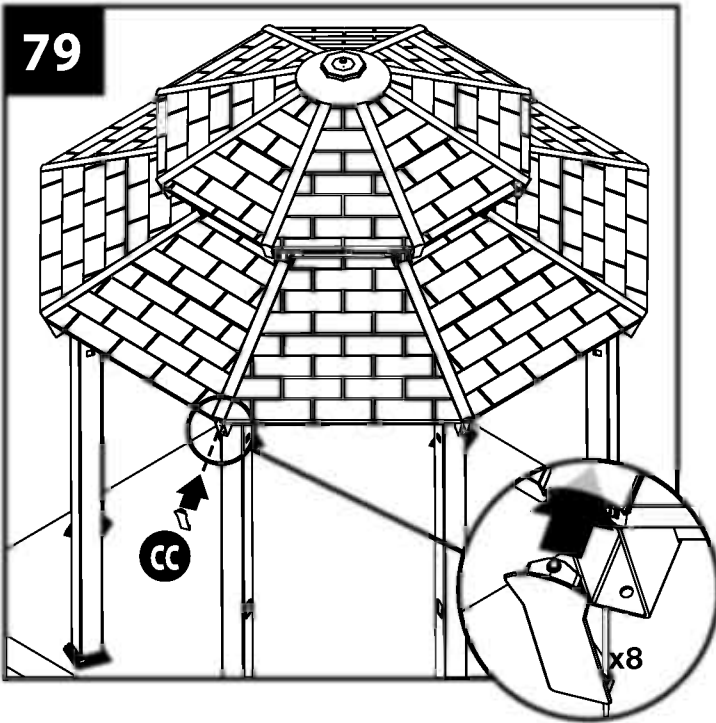

79 Snap one lower roof end caps onto lower rafters. Repeat for remaining seven lower roof rafters.

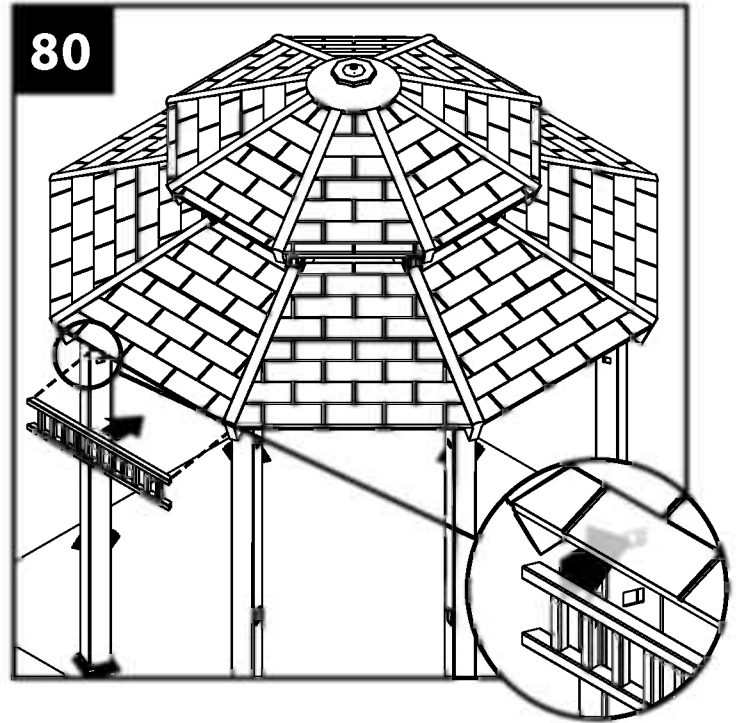

80 Insert one pre-assembled lower roof railing between roof support posts. (Ensure rails are centered.)

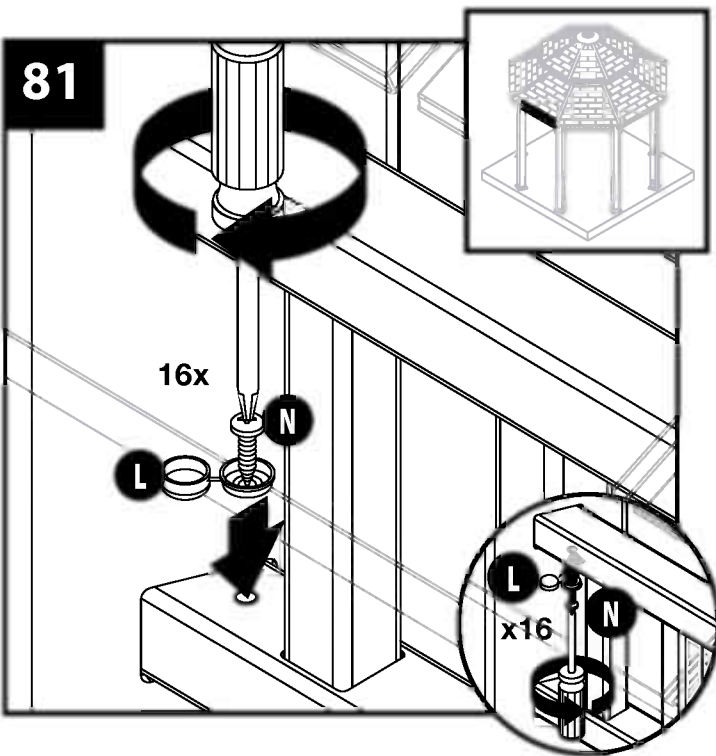

81 Insert flathead screw through cap and screw into pre-drilled holes (top and bottom) of lower roof railings. (Four per rail).

82 Repeat steps 80-81 for remaining seven lower roof rails.

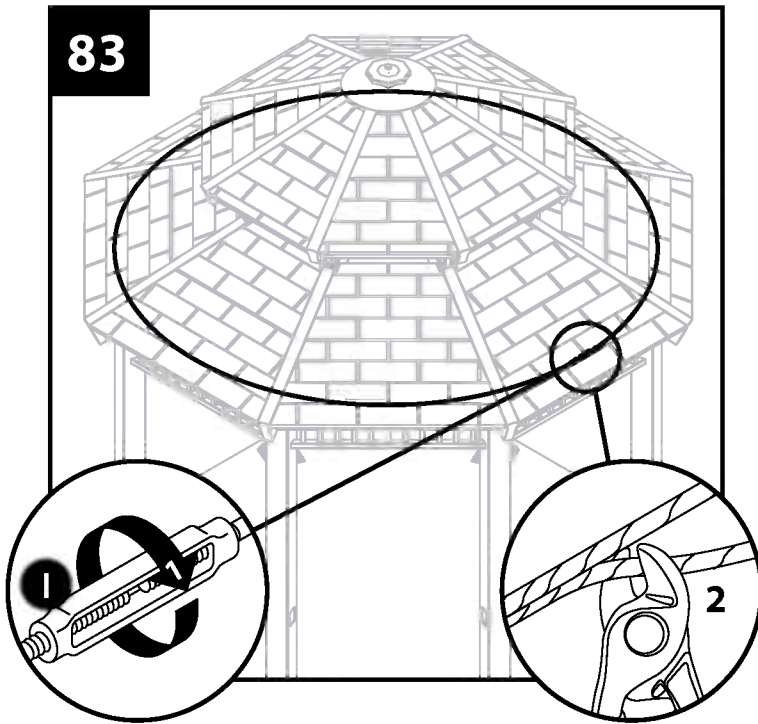

Using a wire cutter or hacksaw, cut off **EXCESS** cable beyond clamp. **DO NOT** cut the portion of the cable that runs through the dowels pins and around the gazebo. This is a structural component of the gazebo that must not be moved.

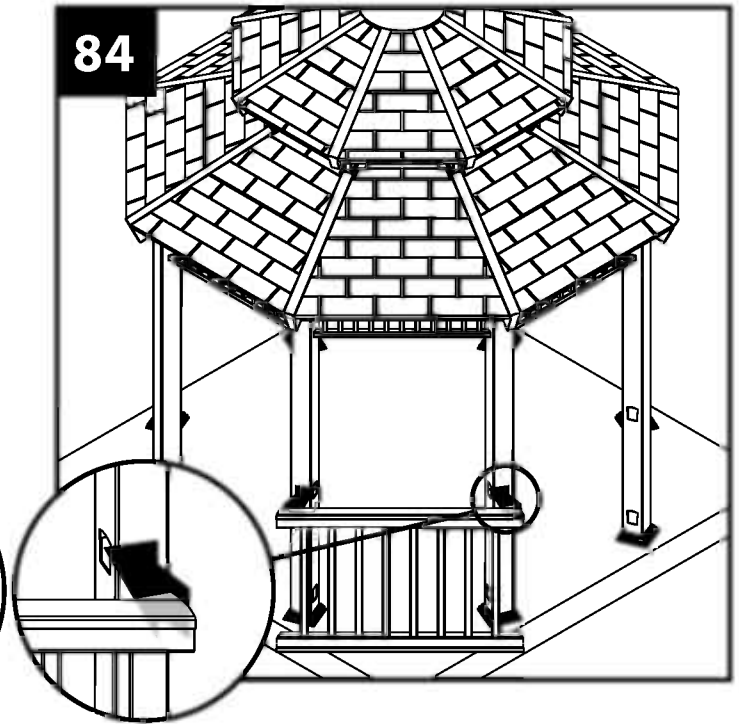

Starting at one side of the doorway, insert one side of one preassembled hand rail into notches in post. Insert remaining side of hand rail and center between posts.

85

Repeat step 84 for remaining six hand rails.

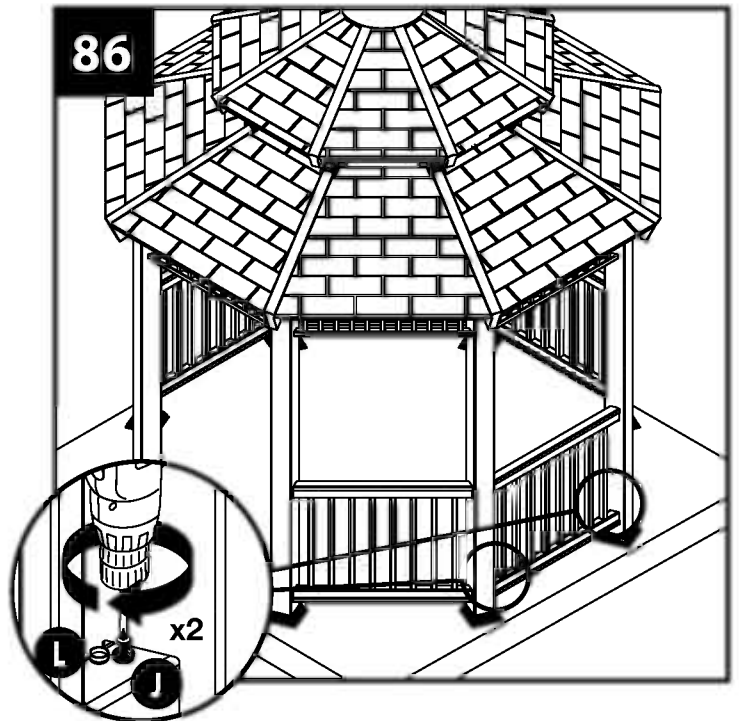

Center hand rail and make sure spindles are vertical. Secure lower handrails using two screws and screw caps per section (top side of bottom hand rail—one per side). Place screws and screw caps as close to post as possible where the hand rail meets the post.

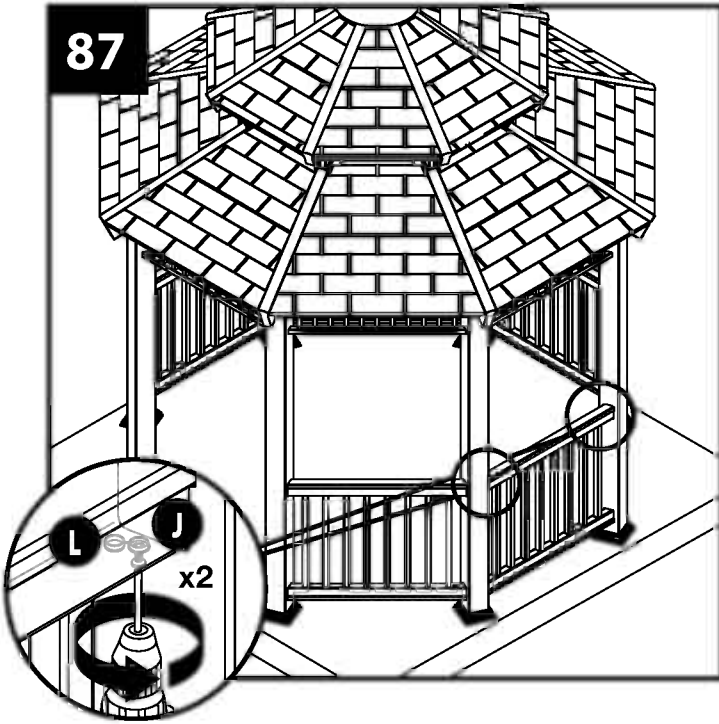
87**88**

Repeat steps 86-87
for remaining
hand rails.

Center hand rail and make sure spindles are vertical. Secure upper handrails using two screws and screw caps per section (underside of top hand rail—one per side). Place screws and screw caps as close to post as possible where the hand rail meets the post.

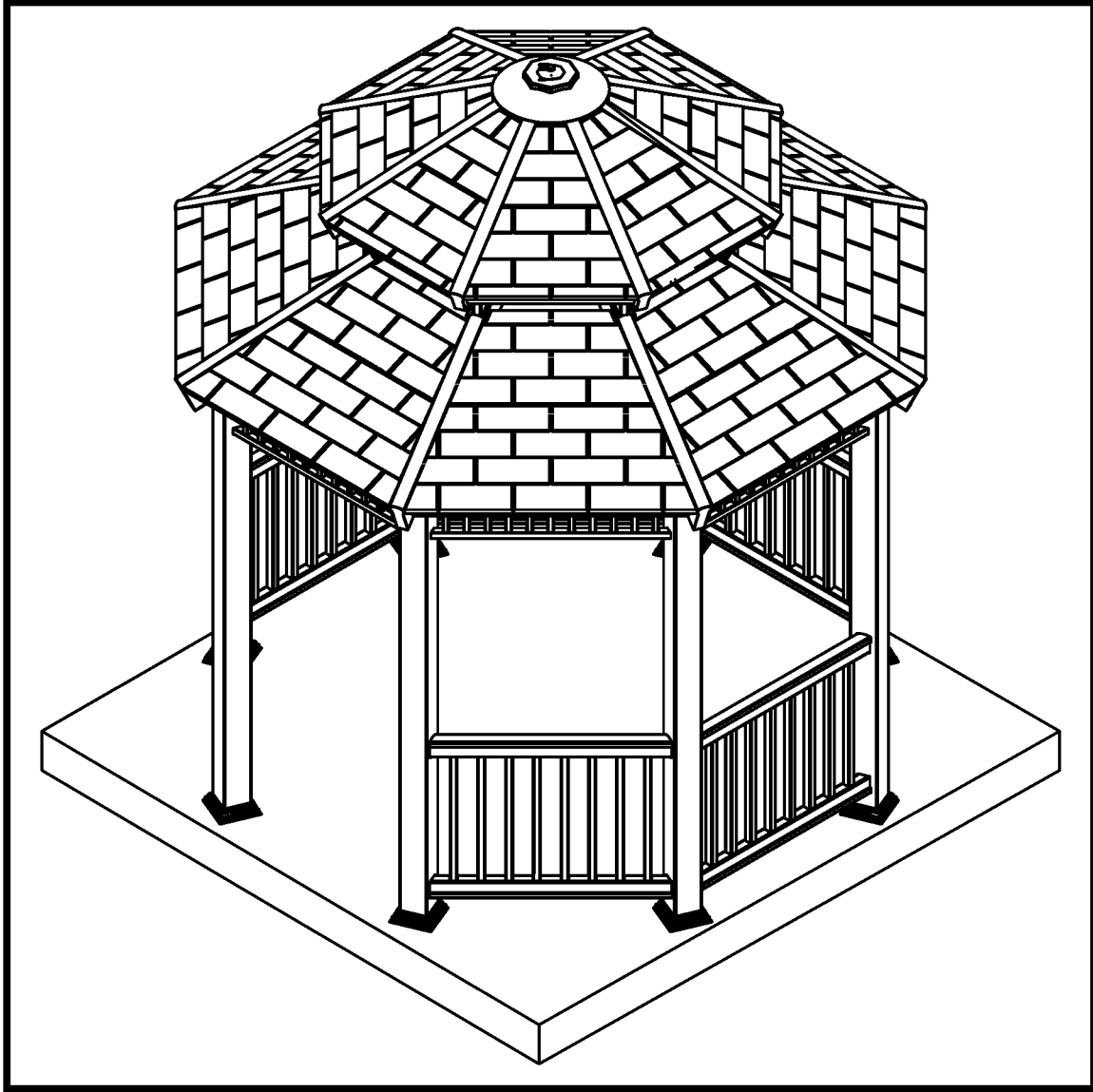

Completed gazebo.

Notes

Notes

Notes

Warranty

Suncast® Corporation, 701 North Kirk Road, Batavia, Illinois 60510 (Manufacturer) warrants to the original purchaser only that the enclosed product is free from material and workmanship defects under normal, household use at time of purchase. Defective product or part must be returned, freight prepaid, to the Manufacturer's address (Attention: Parts Department) along with proof of purchase. Upon receipt of the aforesaid, the defective product or part will be repaired or replaced at the option of the Manufacturer without charge to the original purchaser and returned to the customer freight collect.

This limited warranty does not apply to damage resulting from accident, neglect, misuse, commercial use, alteration, operation not in accordance with instruction or repairs made or attempted by unauthorized persons.

This limited warranty applies only to the product enclosed and does not apply to accessory parts.

THE MANUFACTURER'S LIABILITY HEREUNDER IS LIMITED SOLELY TO THE REPAIR OR REPLACEMENT OF THE DEFECTIVE PRODUCT OR PART AND THE MANUFACTURER SHALL IN NO EVENT BE LIABLE FOR ANY INCIDENTAL OR CONSEQUENTIAL DAMAGES WHICH MAY RESULT FROM ANY DEFECT IN MATERIAL OR WORKMANSHIP OR FROM THE BREACH OF ANY EXPRESS OR IMPLIED WARRANTY.

Some states do not allow the exclusion or limitation of incidental or consequential damages, or a limitation of how long an implied warranty lasts, so the above limitations may not apply to you. This warranty gives you specific legal rights, and you may have other rights which may vary from state to state.

Factory Repairs

Repair service and assembly assistance are available direct from the factory, not from the place of purchase. If this product requires repair, please call or write us. Warranty repair parts are sent out free of charge. If the product is out of warranty, we will inform you of the charges prior to sending out the parts. VISA and MasterCard are accepted on phone orders. For assembly or replacement parts information:

Replacement Parts
Suncast Corporation
701 North Kirk Road
Batavia, IL 60510 USA

Outside Illinois, but within North America
800-846-2345
24 hour service / 7 days a week

Within Illinois, or outside North America
630-879-2050
visit: www.suncast.com
email: parts@suncast.com

PATENTS
Patents pending.

Quality Control Number